



Addendum #1

Project: UO Bowerman Hall Re-Roof
Date: 05/16/2012
To: Bidding Contractors
From: Rowell Brokaw Architects

1.1 GENERAL ITEMS

- A. Sketch SK 051612-2, showing approved staging area attached.
- B. Pre Bid Sign In sheet attached.
- C. There will be no bid bond requirement for this project.
- D. Bid to include \$2,500.00 allowance for replacement of rotted eave and barge boards and miscellaneous trim.
- E. Construction Start Date revised to: July 09, 2012.
- F. The following known black-out dates (all day) apply due to currently scheduled track and field events at Hayward Field: July 14, 15. No weekend work allowed, unless coordinated with and approved by UofO PM.
- G. The following known partial black-out dates (no work after 3pm) apply due to currently scheduled track and field events at Hayward Field: July 18, 19, 25, 26 and August 1, 2. No weekend work allowed, unless coordinated with and approved by UofO PM.

2.1 CHANGES AND CLARIFICATIONS TO THE PROJECT MANUAL

- A. Section 07 3113 Asphalt Shingles Add Paragraph 1.05-C to read:
 - “C. Warranty:
 - 1. The Contractor shall provide a written warranty guaranteeing all roofing and flashing against defects of workmanship and materials for a period of two (2) years from the date of Final Acceptance and shall maintain the re-roofed areas in watertight condition during this period. The warranty shall be delivered to the Owner prior to final acceptance of the Work.
 - 2. The roofing material Manufacturer shall provide a written **thirty (30)** year warranty signed by a corporate officer for an unlimited sum guaranty covering both installation and materials approved by the roofing Manufacturer. The warranty shall include approved substrates and related materials damaged due to failure of the membrane.”

3.1 CHANGES AND CLARIFICATIONS TO DRAWINGS

- A. Plan A1: Add following General Notes:
 - “8. Provide two alternating layers of ¾” plywood on the east side of Bowerman between Bowerman building and the track. Contractor shall guarantee protection of the Hayward track surface, therapy (hot) tubs, and trench drain system adjacent to Bowerman, and that no materials or construction debris lay on that track surface material when

performing loading or unloading operations into a truck. Contractor will be responsible to repair/restore/replace any damage to these and other adjacent structures due to inadequate protective measures during the work.

9. Contractor shall provide all means and methods necessary to protect the recently applied top slurry coat surface on the parking lot at Bowerman. No significant impact to this surface will be anticipated due to the scope of work, beyond normal wear. Contractor will be responsible to repair/restore/replace any damage to the slurry coating in the Bowerman parking lot area due to inadequate protective measures during the work.”

B. Plan A2: Revised Sheet A2 attached.

End of Addendum 1

SCAFFOLDING
REQUIRED HERE
IF ACCESS TO
ENTRY IS
MAINTAINED
& PROTECTED

TEMPORARY
CONSTRUCTION
STAGING AREA,
ONLY AS NEEDED,
COORD ACCESS
W/ UD PM.

Bowerman
Parking
Lot

RESILIENT SURFACE,
CONSTRUCTION TRAFFIC
& STAGING ALLOWED
w/ MIN (2) LAYERS
OF 3/4" PLYWOOD.
REMOVE (5) HOT
TUBES & OTHER
DIVERS EQUIPMENT

Bowerman
HALL

E. 15th AVE

NO CONSTRUCTION
TRAFFIC OR DEBRIS
ALLOWED ON TRACK
SURFACE



SK 051612-2
UD Bowerman Hall Project
RBA N.T.S.





UNIVERSITY OF OREGON

PROJECT: Bowerman Reroof - Pre-Bid Meeting







DATE: 5/10/12

Name	Company	Address	Phone	Email	Signature
DAN WARD	UofO	1295 Franklin Blvd, Eugene, OR 97403	541-346-2147	ward@uoregon.edu	<i>D. Ward</i>
DUSTY STEINMANN	Evergreen	3237 W. 1st Eugene, OR	344-1415	Dusty@EvergreenRoofing.com	
PATRICK GRAY	Umpqua	1610 S. Oak St Eugene, OR	302-6800	umpqua@umpqua-roofing.com	<i>Patrick Gray</i>
JUSTIN PEARSON	Anderson Rfg	1860 Hwy 40 NE Selem, OR	503-378-0183	arsalem@AndersonRfg.com	<i>Justin Pearson</i>
JEREMY MORITZ	Smith Sm	253 S 15th Springfield, OR	786-9194	estimator@smithsheetmetal.com	<i>Jeremy Moritz</i>

GENERAL NOTE

-G.C. RESPONSIBLE FOR PROTECTION OF SURROUNDING SIDEWALKS AND VEGETATION FROM CONSTRUCTION TRAFFIC. PLYWOOD COVERING OF SIDEWALK REQUIRED. TREE ROOT ZONES TO BE PROTECTED WITH CYCLONE FENCING AND GROUND STAKES.

LEGEND

-  CRICKET
-  DIRECTION OF ROOF SLOPE
-  PLUMBING VENT (SIZE APPROX.)
-  DUCT
-  EXISTING ROOF TOP MECHANICAL UNIT
-  EXISTING ELECTRICAL CONDUIT
-  ROOF AREA NOT IN CONTRACT

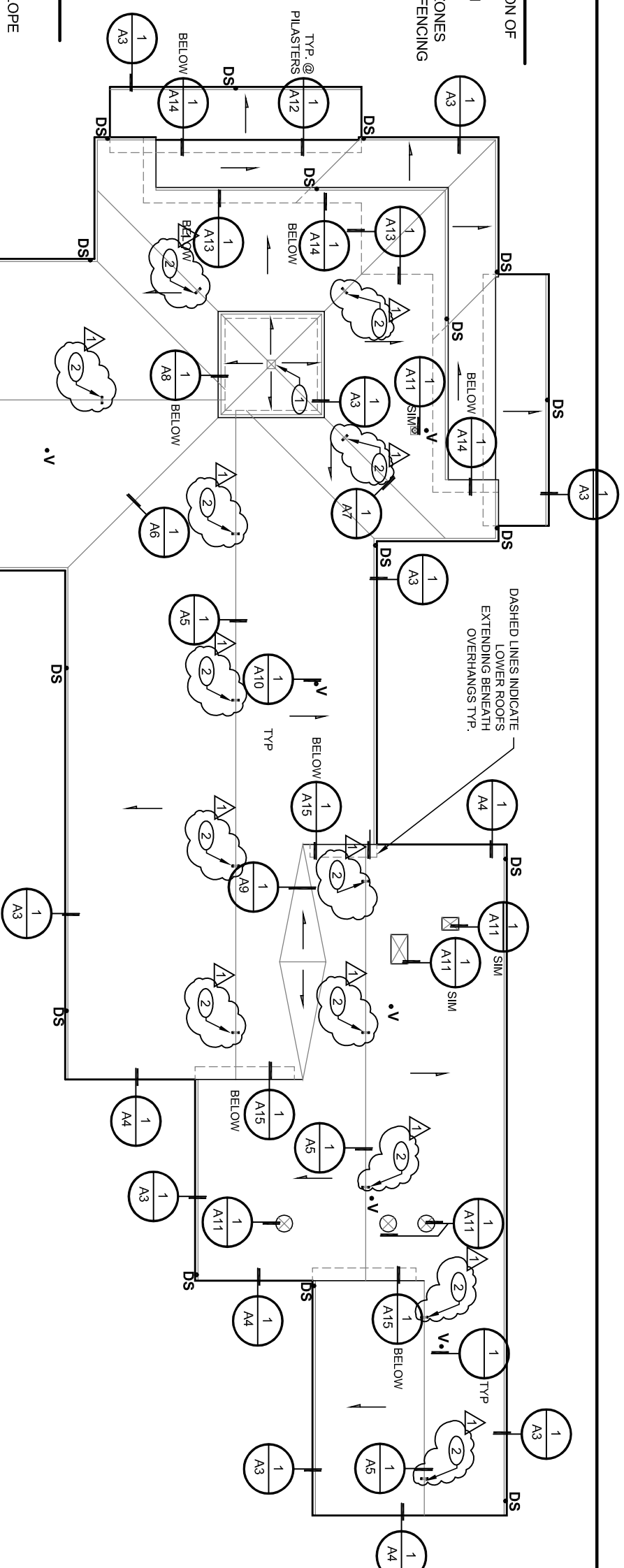

DASHED LINES INDICATE LOWER ROOFS EXTENDING BENEATH OVERHANGS TYP.

KEYNOTES

- (1) REMOVE AND STORE WEATHER VANE AS NECESSARY FOR ROOF INSTALLATION AND REINSTALL.
- (2) (N) PERMANENT FALL PROTECTION MOUNTED UNDER SHINGLES. ATTACH THROUGH SHEATHING TO STRUCTURAL FRAMING. GUARDIAN RIDGE-IT 2 D RING OR SIMILAR.

1 ROOF PLAN
A2 Scale: 1" = 16'-0"



PROJECT #: 1203
DRAWN BY: CA
CHECKED BY: XX
FILE NAME: 1203 - CURRENT
DATE: 04/30/2012 PERMIT/BID
05/16/2012 ADDENDUM 1
PROJECT:

**UO BOWERMAN HALL
ROOF REPLACEMENT**

**Rowell Brokaw
Architects**

Rowell Brokaw Architects, P.C.
One East Broadway, Suite 300
Eugene, Oregon 97401
Voice (541) 485-1003
Fax (541) 485-7344
www.rowellbrokaw.com

A2