

| REVISIONS | | | |
|-----------|------|-----------------------------|-----------|
| REV | DATE | DESCRIPTION | APPROVED |
| 1 | - | UPDATED TO MATCH NEW DESIGN | W. MARCUM |

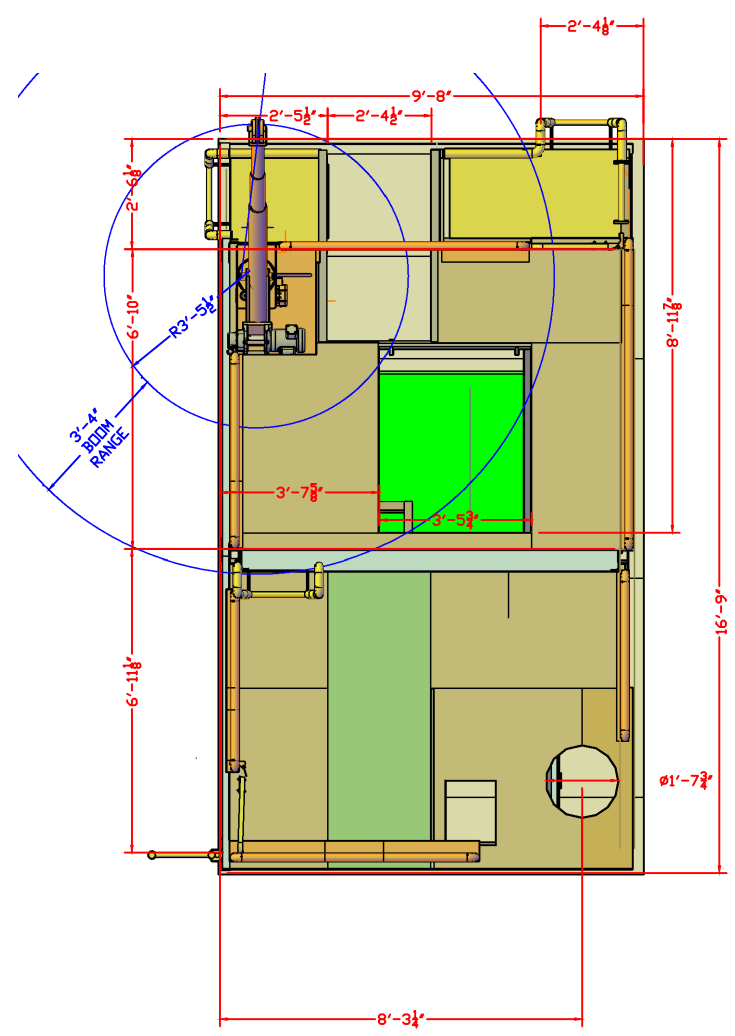

PLAN

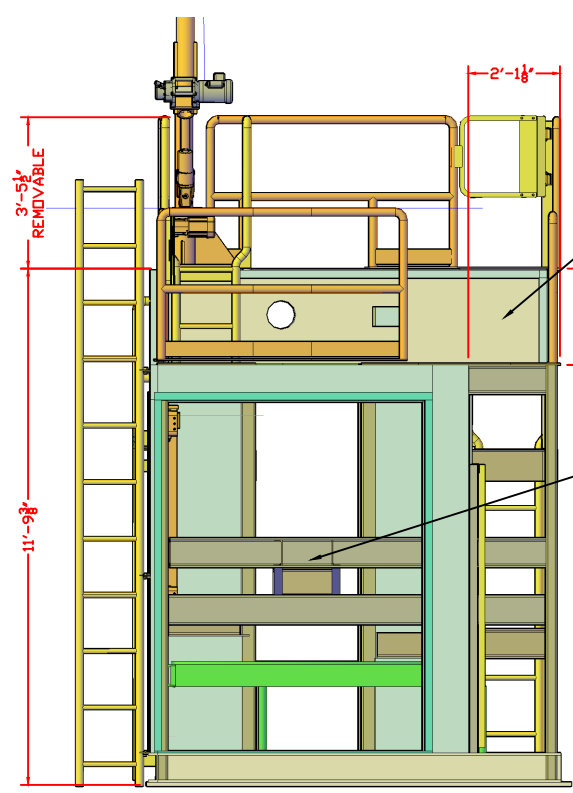

FIRE WALL, INVICATA DURASTEEL PANELS OR EQUAL.

6'X 8' 2 hr Fire-rated double doors.

6'X 6' OPENING FOR CONTROL PANEL. OPENNING TO BE SEALED AFTER PANEL INSTALLED.

6'X 6' OPENING FOR VFD'S AND SCR'S, TWO DOORS WITH SCREENED OPENINGS

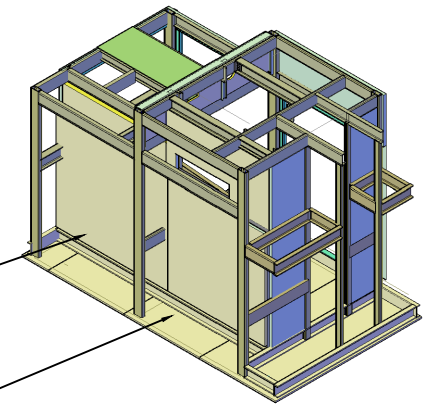

GENERAL STRUCTURAL NOTES

GENERAL: All materials and workmanship shall conform to the Uniform Building Code, (UBC) Current Edition, the local City or County building code, and the requirements of the drawings and specifications. The drawings indicate general and typical details of construction. Where conditions are not specifically indicated, but are of a similar character to details shown, similar details of construction shall be used, subject to approval by the Client and/or Structural Engineer. The Contractor shall provide temporary bracing for the structural components until all final connections have been completed. All structural systems which are composed of components to be field erected shall be supervised by the supplier during manufacturing, delivery, handling, storage, and erection. Erection shall be in accordance with the instructions prepared by the supplier. Verify all existing dimensions and elevations before proceeding with the work. Verify all architectural, mechanical and electrical openings before proceeding with the work. Verify all existing utilities before proceeding with the work.

NON-SHRINK GROUT: Base plate grout shall be non-shrink type with minimum f'c=8,000 psi. All other non-shrink grout shall have f'c=5,000 psi.

STRUCTURAL STEEL: Structural steel shall be as follows:

| Item | ASTM | Fy |
|--|-----------|------------|
| Plates, Shapes / Angles and Rods | A36 | =36 ksi |
| Anchor Bolts (Embedded in Mas. or Conc.) | A307 | Ft =20 ksi |
| Structural Tubing (Square or Rect.) | A500 Gr B | Fy =46 ksi |

Structural steel design, fabrication and installation shall conform to UBC Chapter 22, and shall conform to the latest edition of the AISC Specification for the Design, Fabrication and Erection of Structural Steel for buildings. All members shall be erected with natural mill camber or induced camber up unless noted on plans. All bolts shall be 3/4" diameter unless noted otherwise. Minimum connection shall be 2 bolts unless specifically shown on drawings. Connections are to be as shown on drawings. Alternative connections require approval of Engineer. All welding shall conform to the AWS codes for arc and gas welding in building construction. All welds shall be 3/16" minimum or per section J2 of AISC (whichever is larger), unless otherwise noted. All connections shall be completely welded all around with continuous fillet welds.

Welded joints shall conform to AWS prequalified joint details for welded construction. All welding shall be performed by AWS/ASME Certified welders.

PAINT SPECIFICATION: (1) - Ceracoat C-8200 series High temp coating or equal: Color by Client

COLORS: Structural steel - light grey
Handrails and ladders - safety yellow
SURFACE PREP: SSPC-SP6/NACE 3 Commercial Blast Cleaning

Attach all pipe and electrical support steel prior to painting to avoid paint re-work.

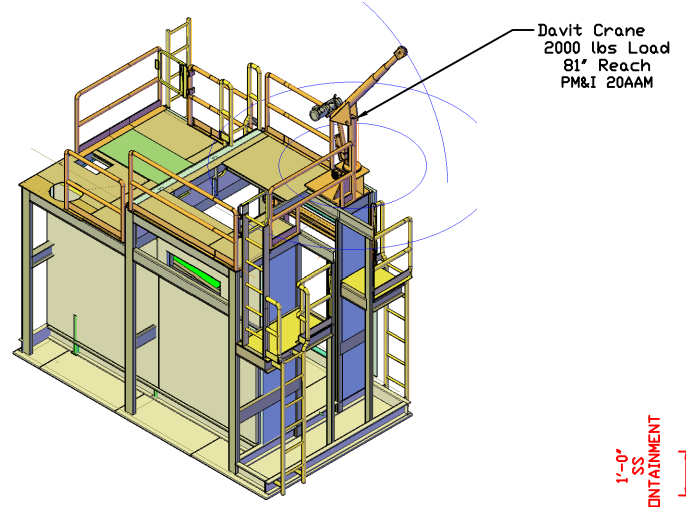

Davit Crane
2000 lbs Load
81' Reach
PM&I 20AAM

JIB CRANE
FOR BARREL HANDLING

GRATING SUPPORT
OVER TANKS

OSU OREGON STATE UNIVERSITY
 NUCLEAR SCIENCE & ENGINEERING THERMAL HYDRAULICS
 SCHOOL OF NUCLEAR SCIENCE AND ENGINEERING
 RADIATION CENTER, CORVALLIS, OREGON 97331
 TELEPHONE: (541) 737-2341 FAX: (541) 737-0480

SoFIE

| | | | |
|----------------------------|--------------------|---------------------------|---|
| DRAWN BY A. WEISS | DATE 05/03/2023 | TITLE STRUCTURE LAYOUT | |
| REVIEWED BY T.K. HOWARD | DATE 05/05/2023 | SIZE B | DWG NO. OSU-SOFIE-100000-DWG-001 |
| APPROVED BY W. MARCUM | DATE 05/08/2023 | SCALE AS NOTED | PROJECT SODIUM FLOW INVESTIGATION EXPERIMENT |
| | | | PAGE 1 OF 2 |



| | | |
|-------------------|---|----------------|
| SIZE B | DWG. NO. DSU-SDFIE-700000-DWG-001 | REV 1 |
| SCALE AS NOTED | PROJECT SODIUM FLOW INVESTIGATION EXPERIMENT | PAGE 2 OF 2 |