



Oregon State University

VALLEY FOOTBALL CENTER IMPROVEMENTS 2023 DESIGN

PROJECT NUMBER: 2450-23

RFP #2023-010737

ADDENDUM NO. 1

ISSUE DATE: March 6, 2023

CONTRACT ADMINISTRATOR:

Brooke Davison, Construction Contracts Officer

Construction Contracts Administration

Email: ConstructionContracts@oregonstate.edu

This Addendum is hereby issued to inform you of the following revisions and or clarifications to the above-referenced RFP and/or the Contract Documents for the Project, to the extent they have been modified herein. Any conflict or inconsistency between this Addendum and the Solicitation Document or any previous addenda will be resolved in favor of this Addendum. Proposals shall conform to this Addendum. Unless specifically changed by this Addendum, all other requirements, terms and conditions of the Solicitation Document and or Contract Documents, and any previous addenda, remain unchanged and can be modified only in writing by OSU. The following changes are hereby made:

MODIFICATIONS:

Item 1 Deadline for Questions is hereby revised to March 7, 2023 at 5 pm.

GENERAL INFORMATION

Item 2 The construction budget is \$8,500,000.00.

Item 3 An Overview Drawing, by HNTB, dated 10/09/2015 is attached for general information purposes.

END OF ADDENDUM NO. 1

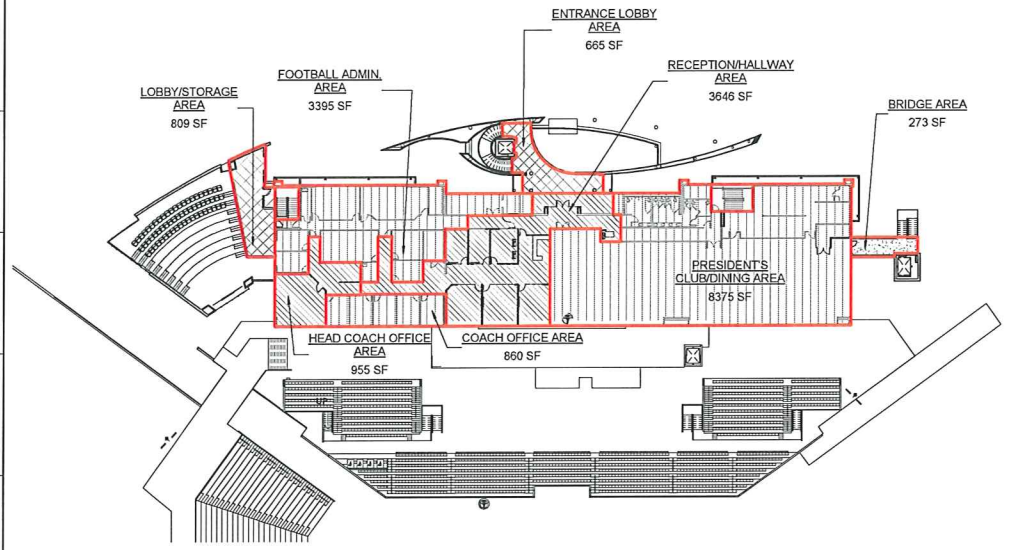

3 LEVEL 3
G005 1/2" = 1'-0"

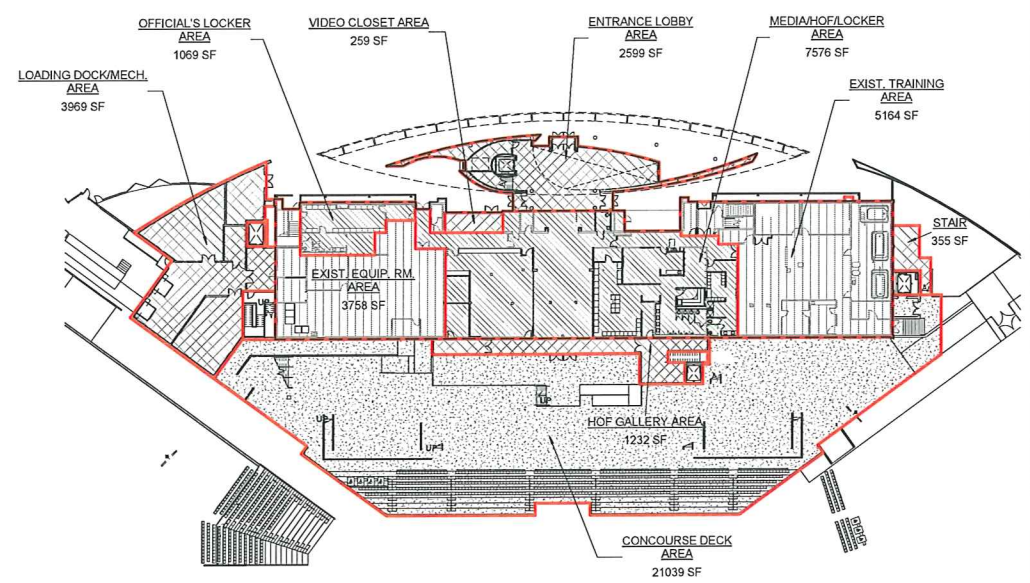

1 LEVEL 1
G005 1/2" = 1'-0"

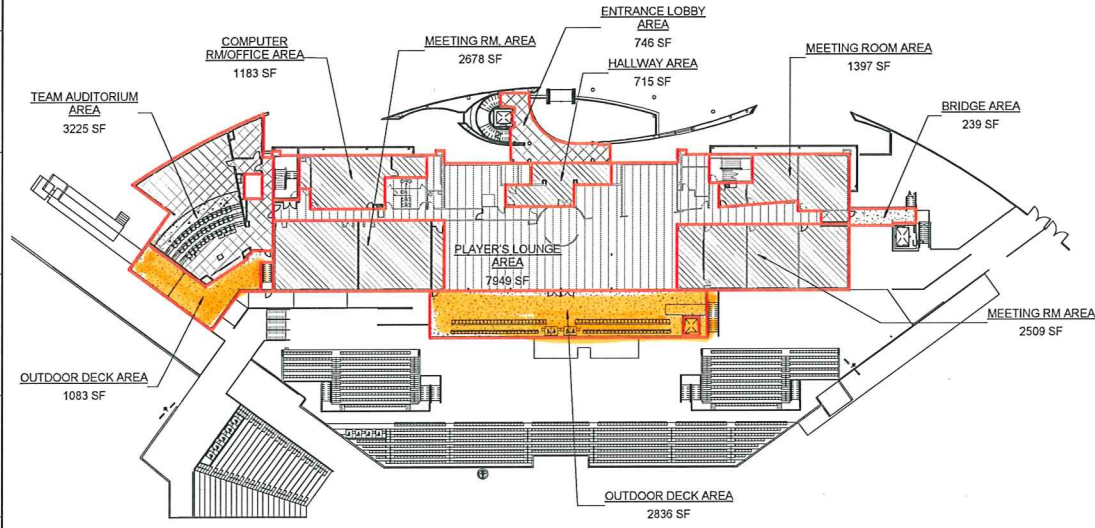

2 LEVEL 2
G005 1/2" = 1'-0"

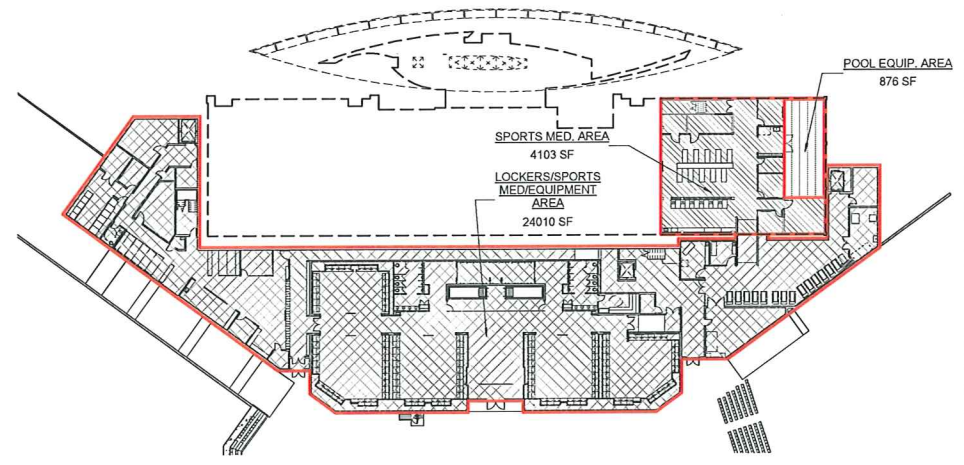

4 FIELD LEVEL
G005 1/2" = 1'-0"

= 4158 SF Exterior Habitable Space

AREA CALCULATIONS				
LEVEL	NEW CONSTRUCTION AREA	RENOVATION AREA	CONCOURSE AREA DECK	EXISTING TO REMAIN AREA
VFC BASEMENT	24010 SF	4103 SF	0 SF	876 SF
VFC LEVEL 1	8415 SF	8645 SF	21039 SF	8923 SF
VFC LEVEL 2	3971 SF	8482 SF	4158 SF	7949 SF
VFC LEVEL 3	1474 SF	4601 SF	273 SF	12629 SF
TOTAL AREA	37870 SF	25831 SF	25470 SF	30378 SF

63,340 SF New Space

- Building Area Legend**
- CONCOURSE AREA DECK
 - EXISTING TO REMAIN AREA
 - NEW CONSTRUCTION AREA
 - RENOVATION AREA

SHEET NOTES

HNTB
HNTB Oregon Architecture, P.C.
One Bunker Hill
601 West Fifth Street, Suite 1000
Los Angeles, CA 90071
(213) 403-1000 / Fax (213) 403-1001

STRUCTURAL:
KPFF Consulting Engineers
111 SW Fifth Avenue, Suite 2500
Portland, OR 97204
PH (503) 227-3251/FAX (503) 227-7980

CIVIL:
KPFF Consulting Engineers
111 SW Fifth Avenue, Suite 2500
Portland, OR 97204
PH (503) 542-3251/FAX (503) 274-4681

LANDSCAPE:
Mayer / Reed
319 SW Washington Street, Suite 820
Portland, OR 97204
PH (503) 223-5953/FAX (503) 223-8076

SIGNAGE & GRAPHIC:
Mayer / Reed
319 SW Washington Street, Suite 820
Portland, OR 97204
PH (503) 223-5953/FAX (503) 223-8076

MECHANICAL & PLUMBING:
Systems West Engineers
411 High Street
Eugene, OR 97401
PH (541) 342-7210/FAX (541) 342-7220

ELECTRICAL & LIGHTING:
Stadlin
733 SW Oak Street, Suite 200
Portland, OR 97205
PH (503) 273-0094

FIRE PROTECTION & CODE:
FP&C Consultants Inc.
One Ward Parkway, Suite 200
Kansas City, MO 64112
PH (816) 931-3377/FAX (816) 931-3378

SOUND/AV TEL:
VJHV
3424 Midcourt Rd, Suite 124
Camellion, TX 75006
PH (972) 934-3700/FAX (972) 934-3720

ELEVATOR CONSULTING:
ECS
15600 NE 8th Street, Suite B1, PMB 148
Bellevue, WA 98008
PH (425) 957-4641

REFERENCE KEYNOTE

SPEC.#	DESCRIPTION
--------	-------------

VALLEY FOOTBALL CENTER/
NORTH END ZONE RENOVATION
OREGON STATE UNIVERSITY
CORVALLIS, OREGON



NOT FOR CONSTRUCTION

**50%
CONSTRUCTION
DOCUMENTS SET**

DATE	10.09.2015	
ISSUED FOR:	50% CONSTRUCTION DOCUMENTS SET	
PROJECT NO.	60502	
DRAWN BY		
CHECKED BY		
APPROVED BY		
#	DATE	DESCRIPTION

SHEET TITLE & NUMBER
AREA
CONFIRMATION

G005

Copyright HNTB 2015

50% CONSTRUCTION DOCUMENTS SET