



Oregon State University

**Construction Contracts
Administration, Procurement
Contracts & Materials
Management (PCMM)**
Oregon State University
644 SW 13th Ave.
Corvallis, Oregon 97333

P 541-737-4261
F 541-737-5546
oregonstate.edu

2/20/2019

Oregon State University
Construction Contract Administration
Hawley Hall Roof Replacement

ADDENDUM NO. 2

THIS ADDENDUM IS BEING ISSUED for clarification and/or revisions of the drawings and specifications as noted. This document is hereby made a part of the Contract Documents to the extent as though it was originally included herein.

The following changes shall be made to the TECHNICAL SPECIFICATIONS:

Item 1 UPDATE details sheet A8.1 section 5, A8.1 Parapet@ Pipe Chase. See Attached Drawing.

QUESTIONS/ANSWERS:

- Item 2 **Question:** There is no specification for metal fabrications, especially pertaining to the crossover stair. Would you please have the designer provide this? Will there be a deferred submittal required for this portion of the work?
Answer: The Crossover Stair and ladder are Off-the-Shelf Items with the Manufacturer Contact Info listed. Any Metal Fabrication will require shop drawings stamped by a Structural Engineer licensed in the State or Oregon.
- Item 3 **Question:** 15/A8.2 indicates prep and paint entire existing railing – please provide specifications for that scope.
Answer: See Painting Specification Section 099100; PART 2 & PART 3.
- Item 4 **Question:** Please provide Fall Protection locations and specification, if part of the project – see details 13/A8.2 and 4/A8.3.
Answer: See Specification Section 075215; 2.04 Accessories; Paragraph “L”. Locations indicated on Drawings Sheet A2.2. See Legend of Symbols “FPA” and indications on Plan.
- Item 5 **Question:** Please provide warning line specifications.
Answer: See Specification Section 075215; 2.04 Accessories; Paragraph “M”.

END OF ADDENDUM NO. 2

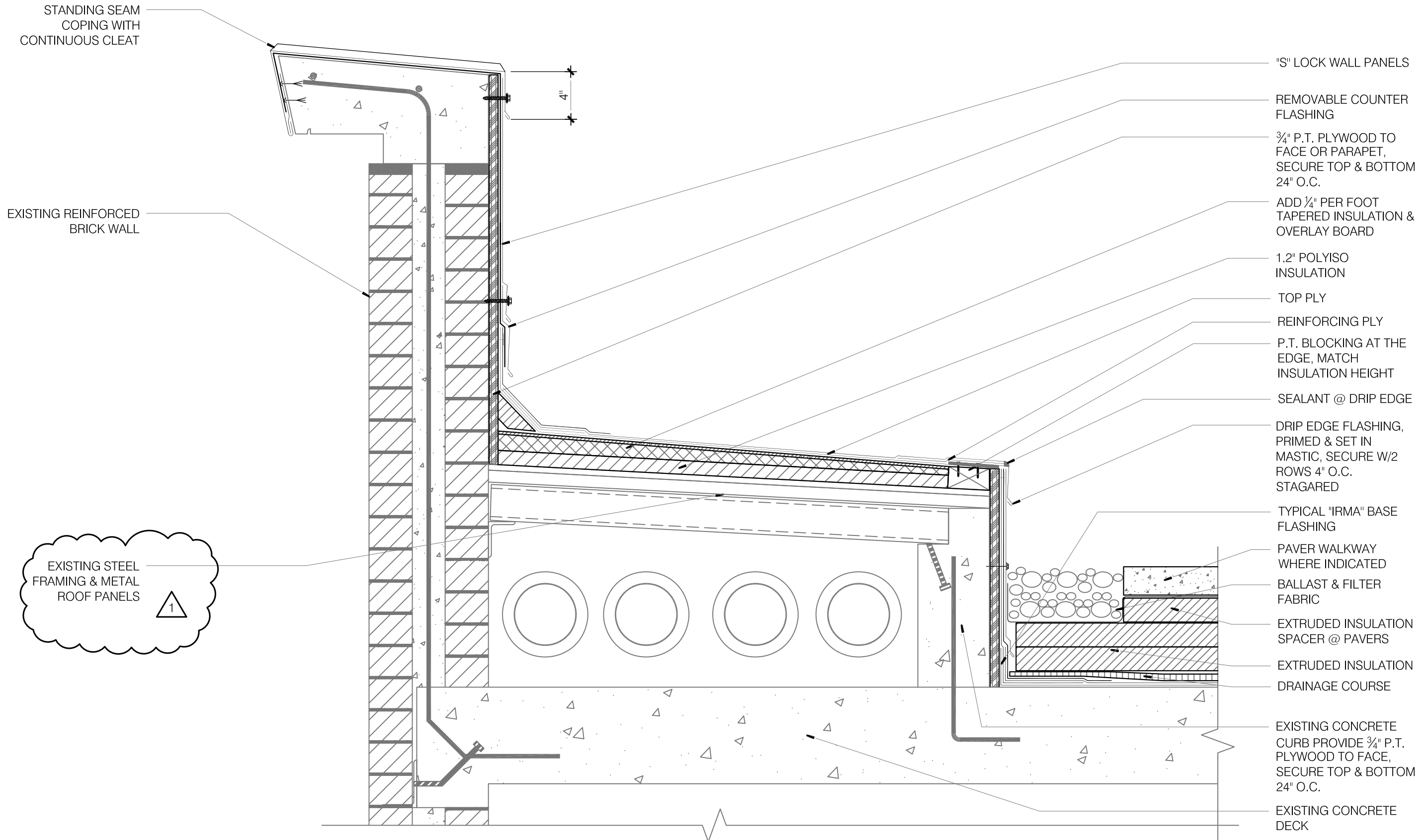

STANDING SEAM
COPING WITH
CONTINUOUS CLEAT

EXISTING REINFORCED
BRICK WALL

EXISTING STEEL
FRAMING & METAL
ROOF PANELS

"S" LOCK WALL PANELS

REMOVABLE COUNTER
FLASHING

3/4" P.T. PLYWOOD TO
FACE OR PARAPET,
SECURE TOP & BOTTOM
24" O.C.

ADD 1/4" PER FOOT
TAPERED INSULATION &
OVERLAY BOARD

1.2" POLYISO
INSULATION

TOP PLY

REINFORCING PLY

P.T. BLOCKING AT THE
EDGE, MATCH
INSULATION HEIGHT

SEALANT @ DRIP EDGE

DRIP EDGE FLASHING,
PRIMED & SET IN
MASTIC, SECURE W/2
ROWS 4" O.C.
STAGARED

TYPICAL "IRMA" BASE
FLASHING

PAVER WALKWAY
WHERE INDICATED

BALLAST & FILTER
FABRIC

EXTRUDED INSULATION
SPACER @ PAVERS

EXTRUDED INSULATION
DRAINAGE COURSE

EXISTING CONCRETE
CURB PROVIDE 3/4" P.T.
PLYWOOD TO FACE,
SECURE TOP & BOTTOM
24" O.C.

EXISTING CONCRETE
DECK

5
A8.1

PARAPET @ PIPE CHASE

1-1/2" = 1' - 0"