

**Irwin Seating Company**

TELESCOPIC DIVISION  
 US ROUTE 40 EAST  
 PO BOX 320  
 ALTAMONT, IL 62411  
 Toll Free: (877) 597-1122  
 Phone: (618) 483-6157  
 Fax: (618) 483-5539  
 www.irwinseating.com

**NOTES:**

ALL VERIFIABLE DIMENSIONS ARE SUBJECT TO CHANGE PENDING FIELD VERIFICATION.

FLOOR SHALL BE SMOOTH AND LEVEL, WITH SLOPE NOT TO EXCEED 1/8" IN 10'-0". (ALTERNATIVELY RECOMMEND FF50/FL35)

IF WALL COLUMNS OR OTHER OBSTRUCTIONS EXIST IN PROPOSED BLEACHER AREA, VERIFY TYPE, LOCATION, WIDTH, & DEPTH.

RISER HEIGHTS EXCEEDING 3/16" VARIANCE FROM ONE TO ANOTHER SHALL BE INDICATED BY A YELLOW NON-SLIP TREAD ON THE NOSE OF EACH RISE.

SEATING NUMBERING TO PRESENTED ON OVERALL SEATING MANIFEST

RELEASE A: 554 SEATS  
 RELEASE B: 306 SEATS  
 RELEASE C: 423 SEATS  
 RELEASE D: 192 SEATS  
 TOTAL: 1475 SEATS

**REQUIREMENTS:**  
 MODEL 4500  
 SHIPPING KD

**SEATING INFORMATION:**

Chair Size	10"	-	-	-	-	Total Seat Count
Chair Qty.	306					306

**BLEACHER SEATING**

	MODEL	COLOR(S)/UPHOLSTRY
Seat Plastic	10" INFINITY	BLACK
Back Plastic	N/S	N/A

**SEATING INFORMATION:**

Chair Size	10"	-	-	-	-	Total Seat Count
Chair Qty.	746					746

**BLEACHER SEATING**

	MODEL	COLOR(S)/UPHOLSTRY
Seat Plastic	10" INFINITY	BLACK
Back Plastic	N/S	N/A

**SEATING INFORMATION:**

Chair Size	19 1/2"	20"	20 1/2"	21"	21 1/2"	Total Seat Count
Chair Qty.	8	139	120	156	0	423

**CHAIR SEATING**

	MODEL	COLOR(S)/UPHOLSTRY
Seat Plastic	INTEGRA	BLACK
Back Plastic	INTEGRA	BLACK
ARM 1	INTEGRA	BLACK
ARM 2	N/A	N/A
Seat Fabric	Directional	CM1 ILLUSIONS BLACK
Back Fabric	Directional	CM1 ILLUSIONS BLACK
Chair Rail	Aluminum	Black Anodized

No.	Revision/Issue	Rev Date	Drafter Initials	Apprv'd Date	Engineer Initials
C	MADE FPD	8/11/16	SML		
B	REV. PER MARKUPS	07/11/16	CJS	07/19/16	AZB
A	MADE SHOPS/APPLIED SCAN	07/11/16	GAW	07/19/16	AZB

**OREGON STATE UNIVERSITY**  
**CORVALLIS, OR**

**BUILDING LAYOUT** DWG. NO. FPD  
 SCALE: 1/8" = 1'  
 DATE: 6/14/16 PRJ. NO. F161238  
 DRAWN BY: CJS SHEET 1 OF 6 REV. NO. C  
 CHECKED BY: AZB 6/16/16

ALTHOUGH BUILDING CODES HAVE BEEN CONSIDERED IN DEVELOPING THIS SEATING PLAN, VERIFICATION OF COMPLIANCE WITH BUILDING CODES IS THE EXCLUSIVE RESPONSIBILITY OF THE CUSTOMER AND/OR ARCHITECT.

**A**  
**1**

**BUILDING LAYOUT**  
 SCALE: 1/8" = 1'-0"

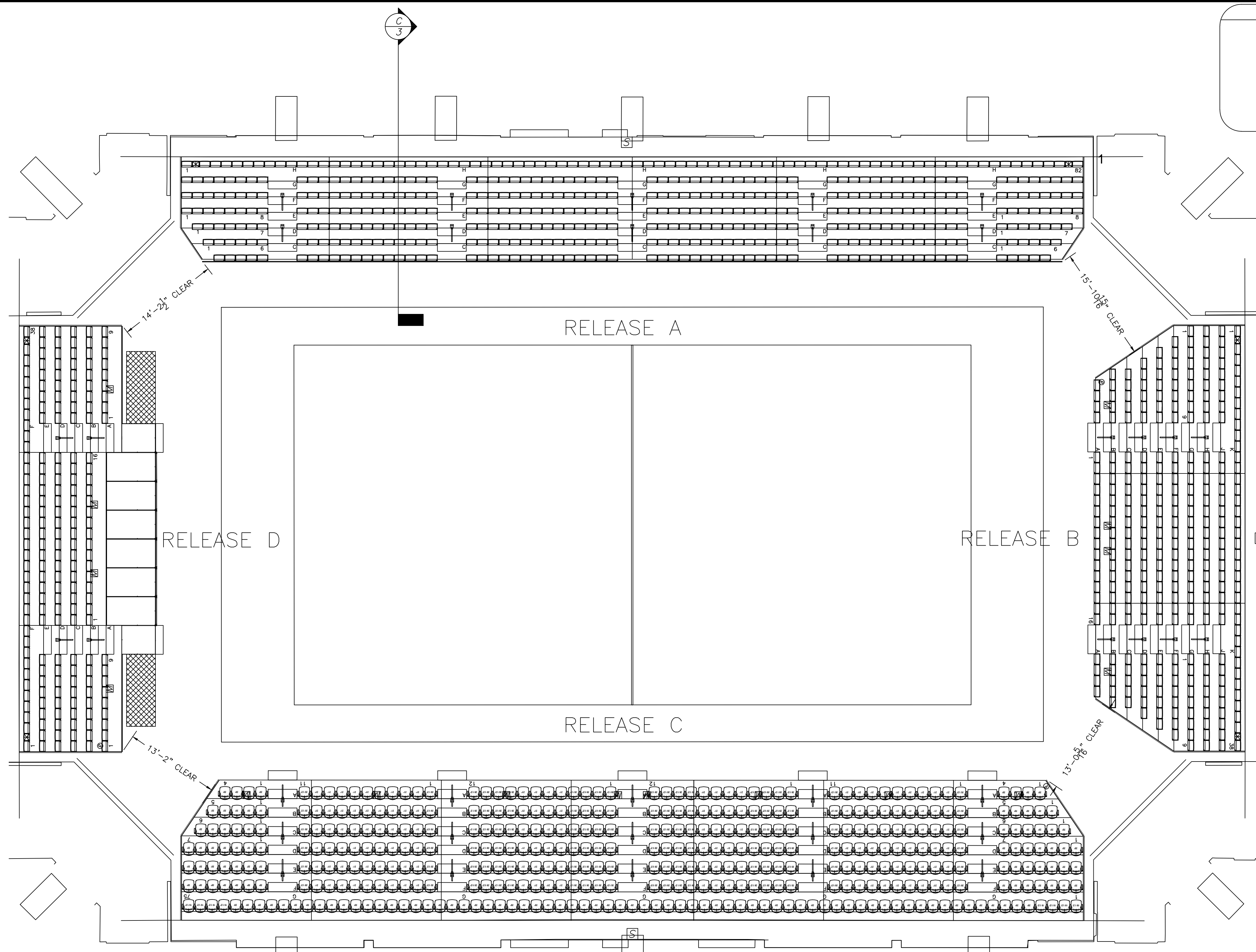

LOCATION MAP

LOCATION	PLAN NORTH
----------	------------

**Irwin Seating Company**

TELESCOPIC DIVISION  
 US ROUTE 40 EAST  
 PO BOX 320  
 ALTAMONT, IL 62411  
 Toll Free: (877) 597-1122  
 Phone: (618) 483-6157  
 Fax: (618) 483-5539  
 www.irwinseating.com

REQUIREMENTS:  
 MODEL 4500  
 SHIPPING KD

C	MADE FPD	8/11/16	SML		
B	REV. PER MARKUPS	07/11/16	CJS	07/19/16	AZB
A	MADE SHOPS/APPLIED SCAN	07/11/16	GAW	07/19/16	AZB
No.	Revision/Issue	Rev Date	Drafter Initials	Apprv'd Date	Engineer Initials

OREGON STATE UNIVERSITY  
 CORVALLIS, OR

BUILDING LAYOUT DWG. NO. FPD  
 SCALE: 1/8" = 1' DATE PRJ. NO. F161238  
 DRAWN BY: CJS 6/14/16 SHEET 1A OF 6 REV. NO. C  
 CHECKED BY: AZB 6/16/16

A  
1A

BUILDING LAYOUT W/RELEASE A 1 ROW PROGRAMMED  
 SCALE: 1/8" = 1'-0"

ALTHOUGH BUILDING CODES HAVE BEEN CONSIDERED IN DEVELOPING THIS SEATING PLAN, VERIFICATION OF COMPLIANCE WITH BUILDING CODES IS THE EXCLUSIVE RESPONSIBILITY OF THE CUSTOMER AND/OR ARCHITECT.

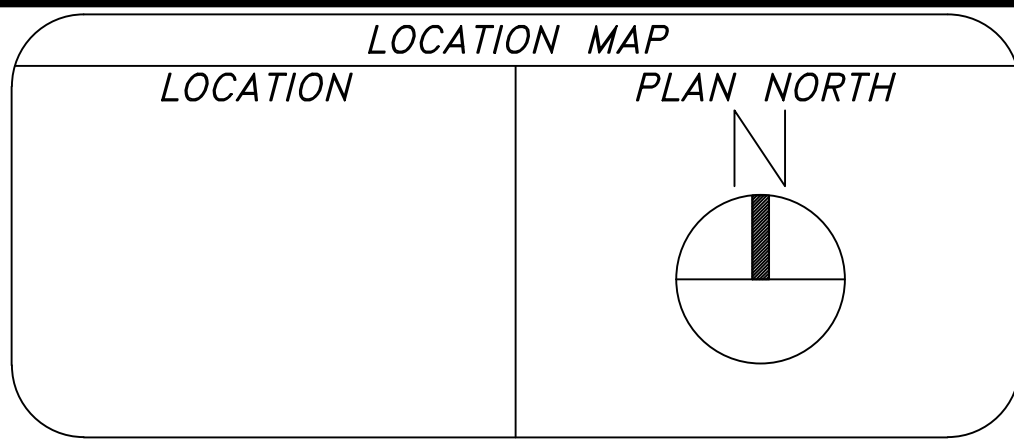

**Irwin Seating Company**

TELESCOPIC DIVISION  
 US ROUTE 40 EAST  
 PO BOX 320  
 ALTAMONT, IL 62411  
 Toll Free: (877) 597-1122  
 Phone: (618) 483-6157  
 Fax: (618) 483-5539  
 www.irwinseating.com

REQUIREMENTS:  
 MODEL 4500  
 SHIPPING KD

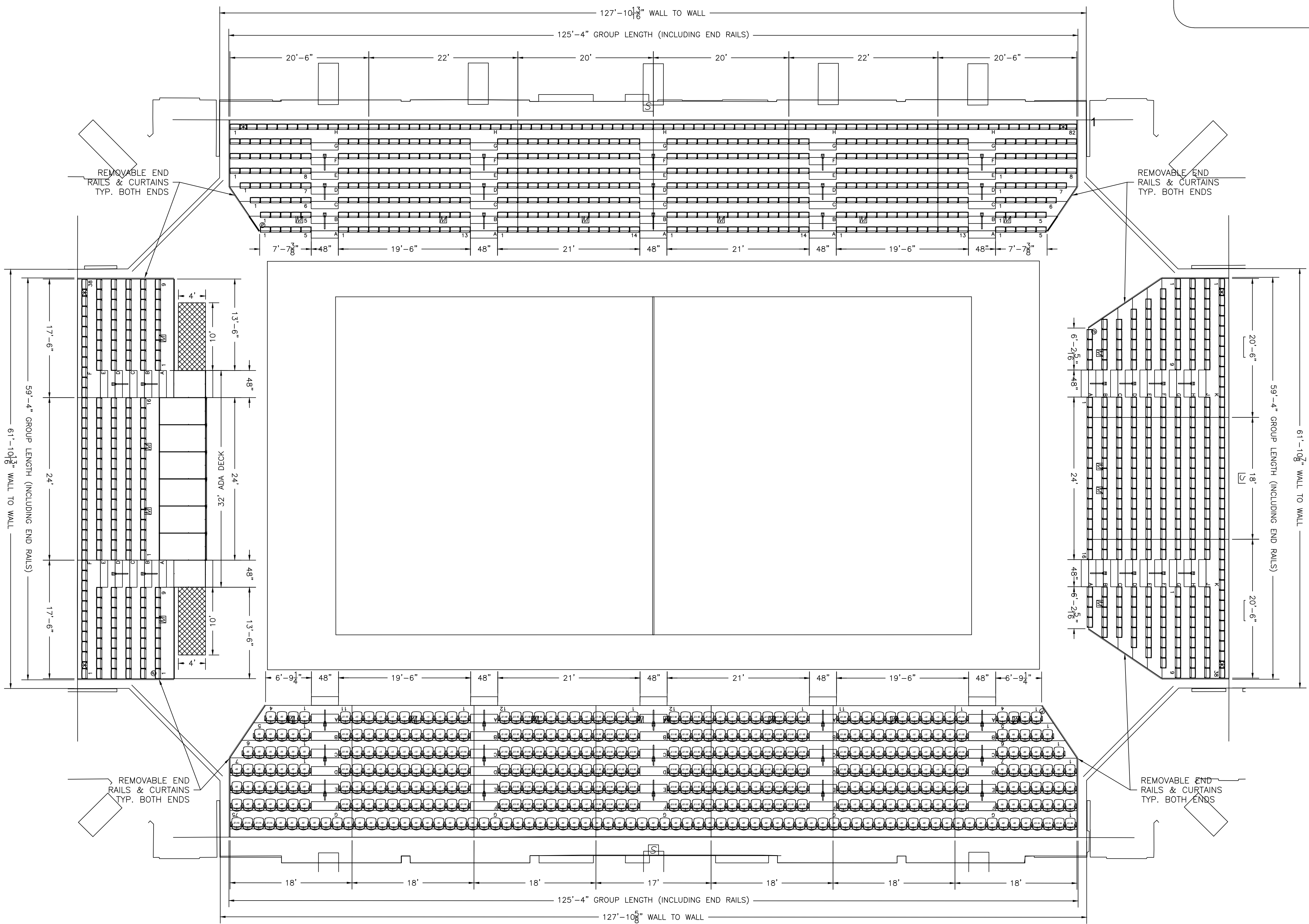

**MATERIALS AND FINISHES**

	MATERIAL	FINISH
Decking:	T&G 3/4" Panelam	#37 GREY
Riser Beam:	A653 Steel	Black Powder Coat
Nose Beam:	A653 Steel	Black Powder Coat
Understructure:	Steel	Black Powder Coat
Guard Rails:	A500B Steel	Black Powder Coat
Handrails:	A500B Steel	Black Powder Coat
Aisle Steps 1:	14 Ga Steel	Black Powder Coat
Aisle Steps 2:	N/A	N/A
Curtains:	14oz Vinyl	BLACK
Vertical Filler:	T&G 5/8" Panelam	Black
Gap Closures:	N/A	N/A
Seat Type 1:	Infinity	BLACK
Seat Type 2:	Integra	BLACK

No.	Revision/Issue	Rev Date	Drafter Initials	Appr'd Date	Engineer Initials
C	MADE FPD	8/11/16	SML		
B	REV. PER MARKUPS	07/11/16	CJS	07/19/16	AZB
A	MADE SHOPS/APPLIED SCAN	07/11/16	GAW	07/19/16	AZB

**OREGON STATE UNIVERSITY**  
**CORVALLIS, OR**

PLAN	DWG. NO. FPD
SCALE: 1/8" = 1'	DATE: 6/14/16
DRAWN BY: CJS	PRJ. NO. F161238
CHECKED BY: AZB	6/16/16
	SHEET 2 OF 6
	REV. NO. C

ALTHOUGH BUILDING CODES HAVE BEEN CONSIDERED IN DEVELOPING THIS SEATING PLAN, VERIFICATION OF COMPLIANCE WITH BUILDING CODES IS THE EXCLUSIVE RESPONSIBILITY OF THE CUSTOMER AND/OR ARCHITECT.

A PLAN VIEW  
 SCALE: 1/8" = 1'-0"

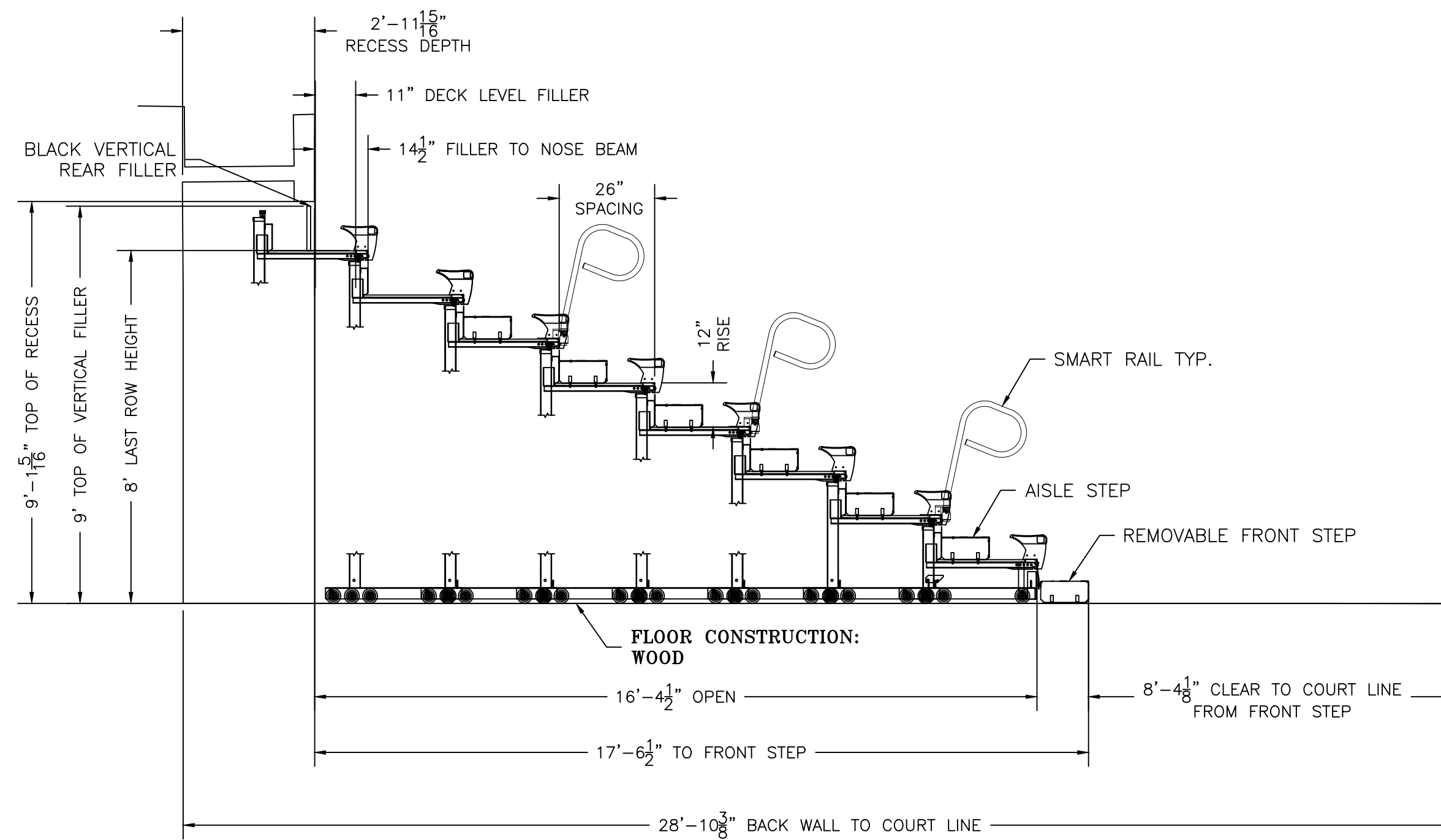
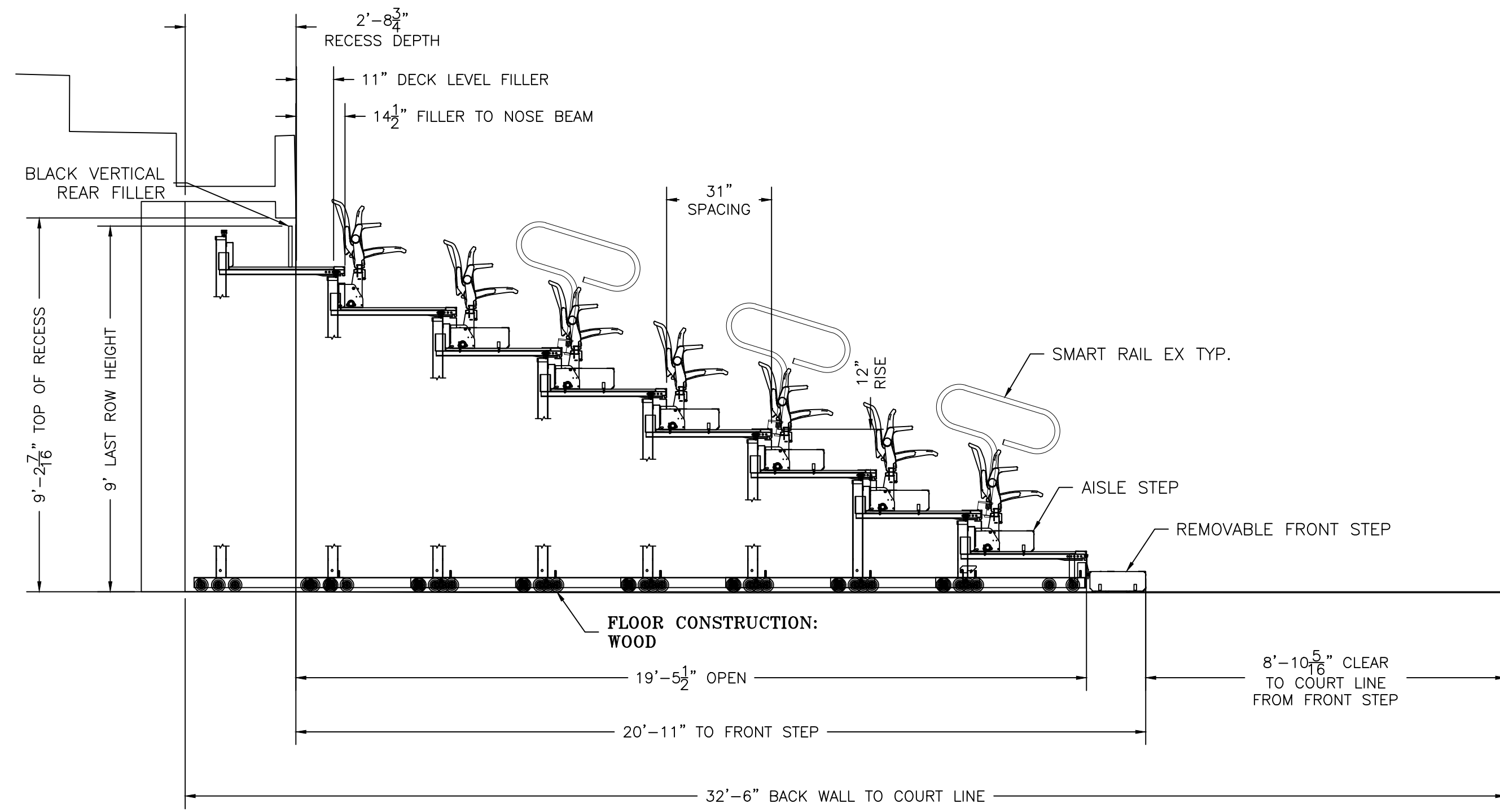

**A**  
**3**  
 7 ROW INTEGRA SIDELINE ELEVATION  
 SCALE: 3/8" = 1'-0"

**B**  
**3**  
 8 ROW INFINITY SIDELINE ELEVATION  
 SCALE: 3/8" = 1'-0"

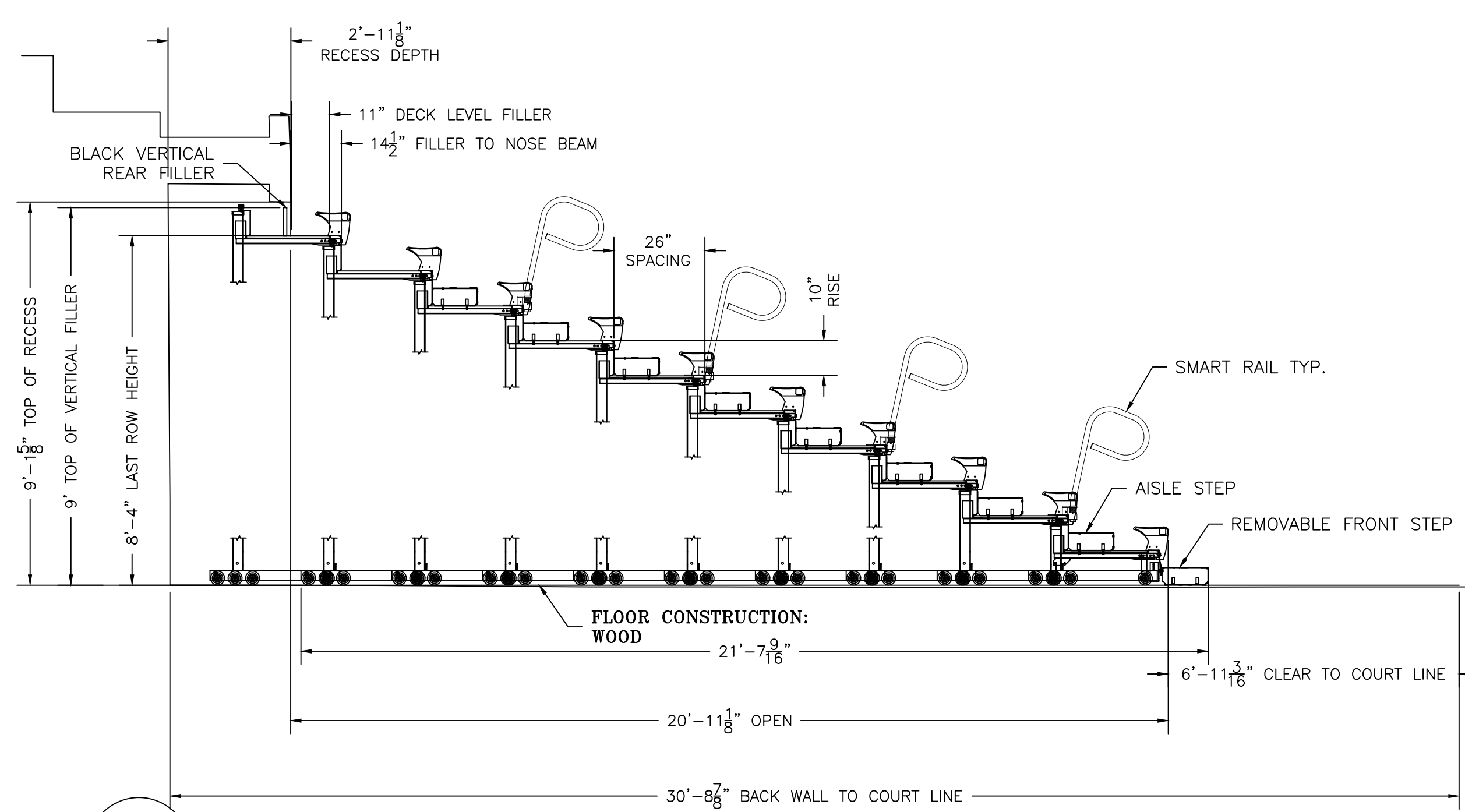
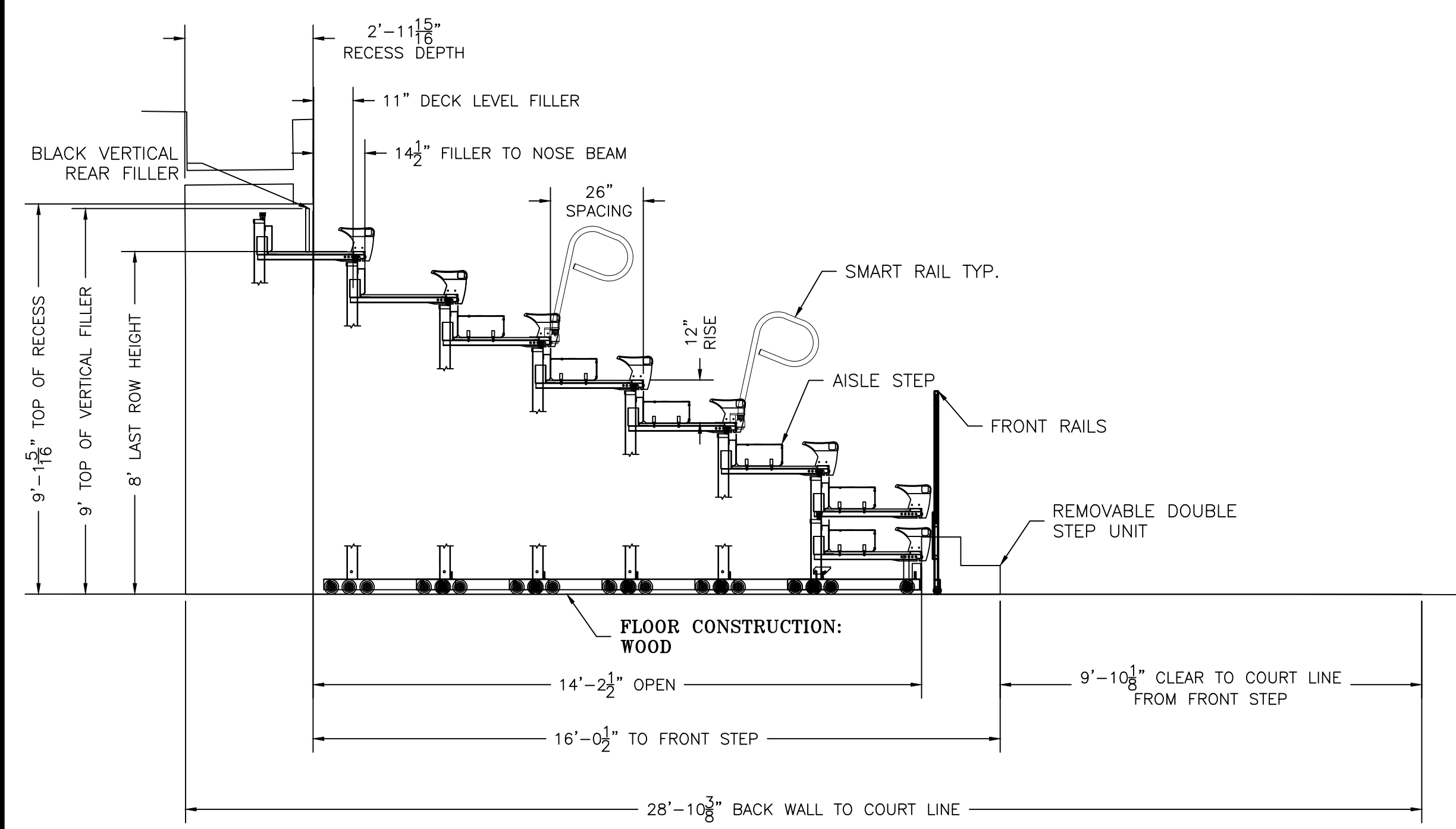

**C**  
**3**  
 8 ROW INFINITY SIDELINE ELEVATION (1 ROW PROGRAMMED)  
 SCALE: 3/8" = 1'-0"

**D**  
**3**  
 10 ROW INFINITY ENDZONE ELEVATION  
 SCALE: 3/8" = 1'-0"

C	MADE FPD	8/11/16	SML		
B	REV. PER MARKUPS	07/11/16	CJS	07/19/16	AZB
A	MADE SHOPS/APPLIED SCAN	07/11/16	GAW	07/19/16	AZB
No.	Revision/Issue	Rev Date	Drafter Initials	Appr'd Date	Engineer Initials

**OREGON STATE UNIVERSITY**  
**CORVALLIS, OR**

ELEVATION DWG. NO. FPD  
 SCALE: 3/8" = 1' DATE PRJ. NO. F161238  
 DRAWN BY: CJS 6/14/16 SHEET 3 OF 6 REV. NO.  
 CHECKED BY: AZB 6/16/16

ALTHOUGH BUILDING CODES HAVE BEEN CONSIDERED IN DEVELOPING THIS SEATING PLAN, VERIFICATION OF COMPLIANCE WITH BUILDING CODES IS THE EXCLUSIVE RESPONSIBILITY OF THE CUSTOMER AND/OR ARCHITECT.

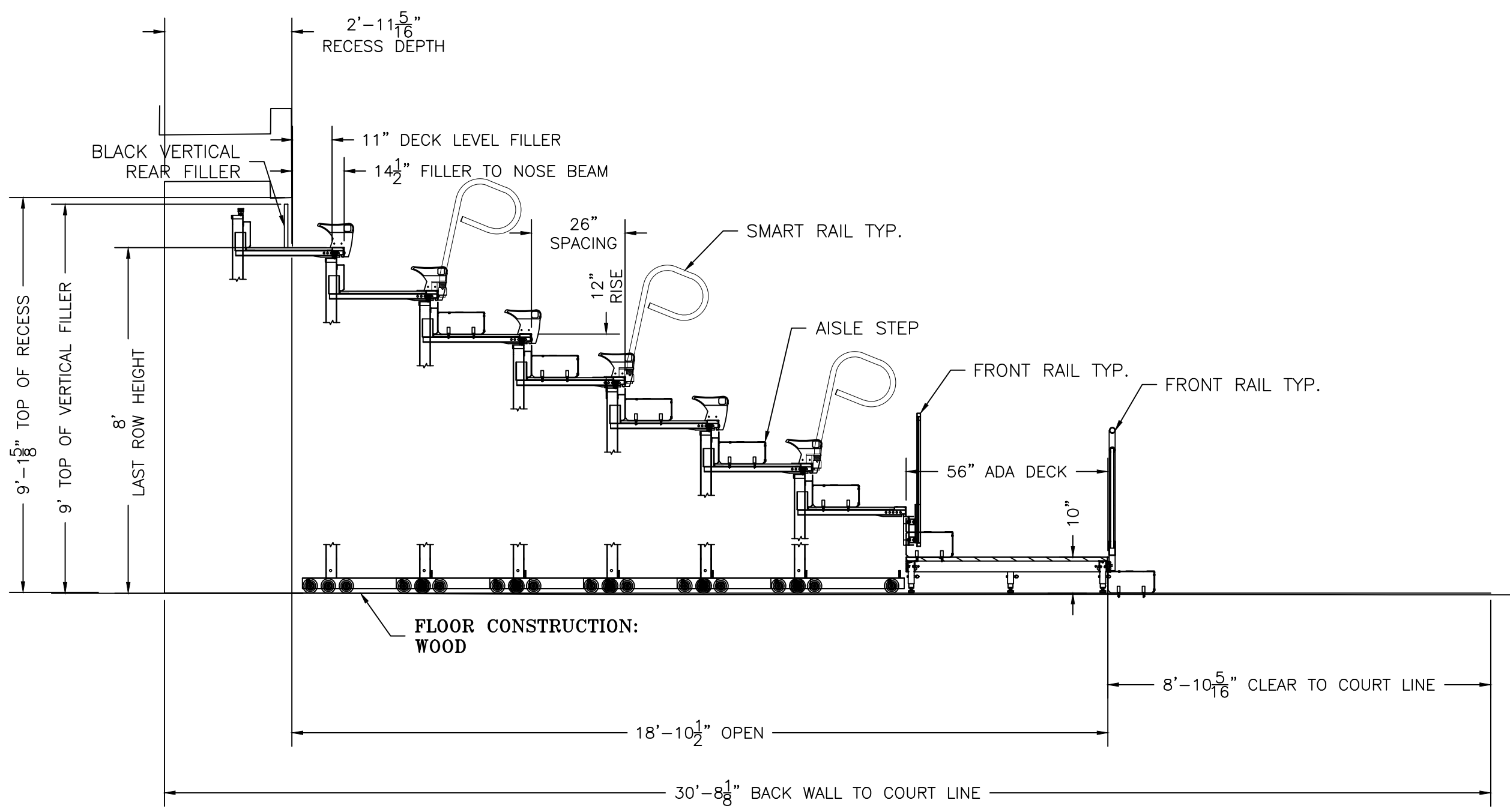

A  
 4  
 6 ROW INFINITY ENDZONE ELEVATION W/ ADA DECK  
 SCALE: 3/8" = 1'-0"

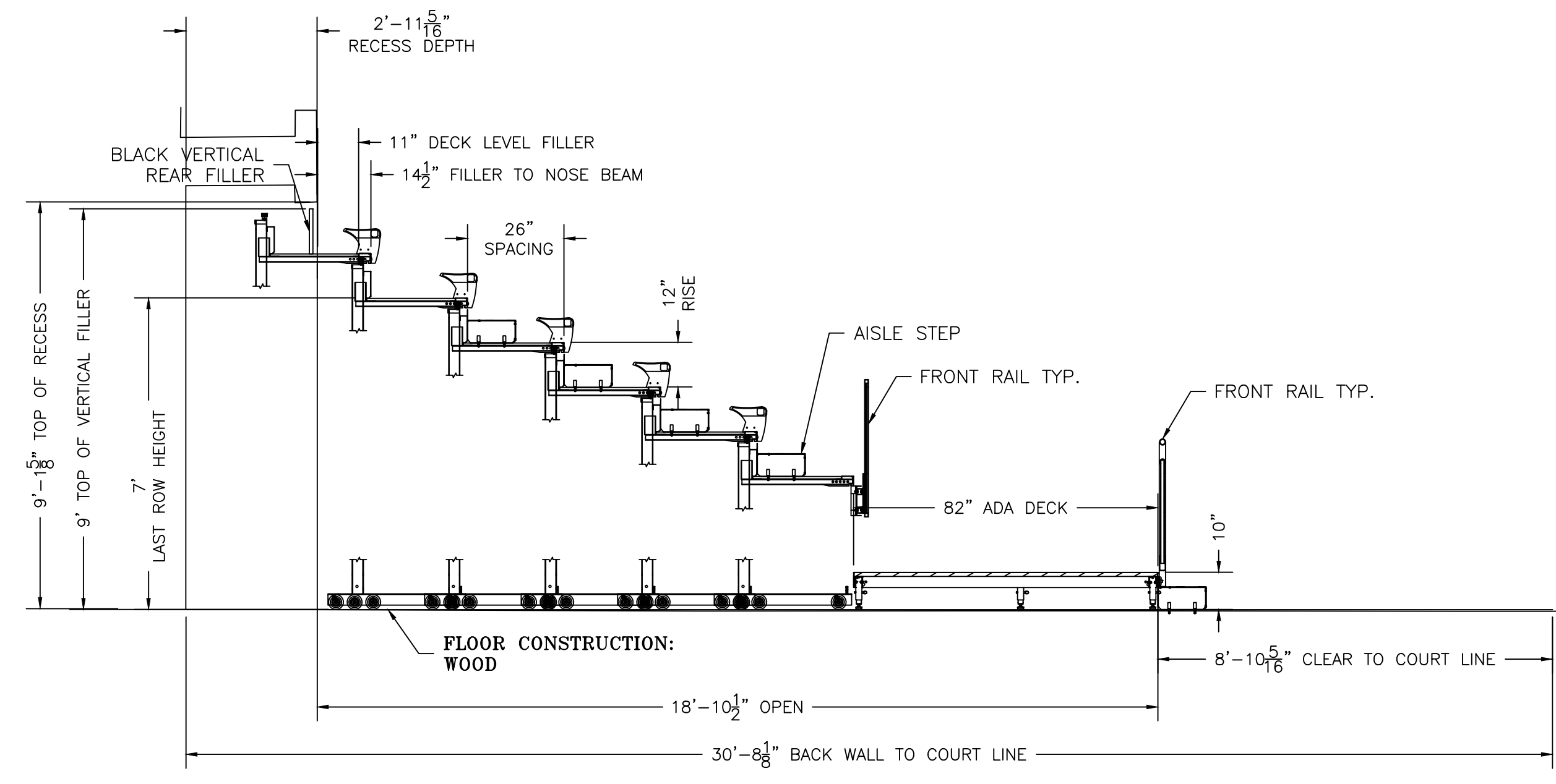

B  
 4  
 6 ROW INFINITY ENDZONE ELEVATION W/ ADA DECK  
 SCALE: 3/8" = 1'-0"

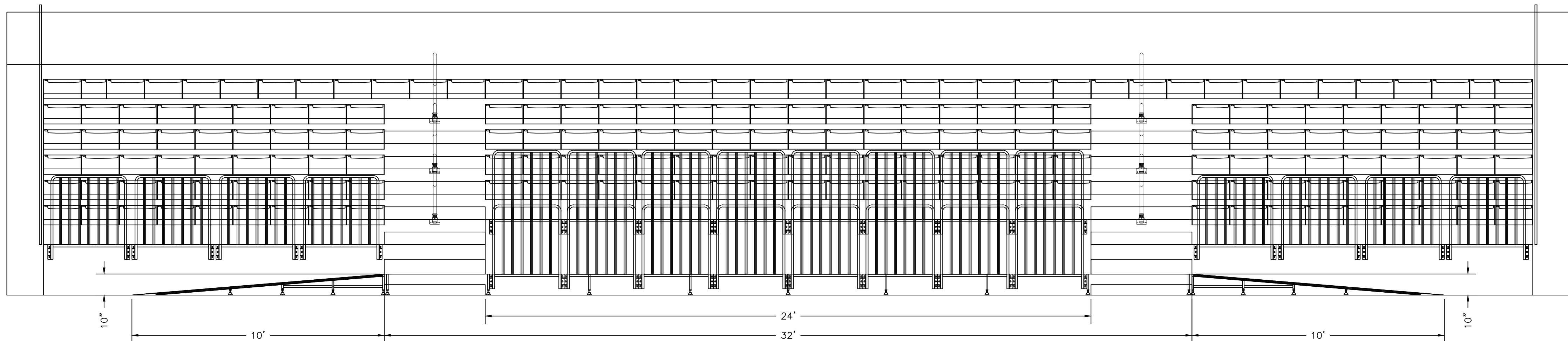

C  
 4  
 FRONT VIEW INFINITY ENDZONE W/ ADA DECK AND RAMPS  
 SCALE: 3/8" = 1'-0"

No.	Revision/Issue	Rev Date	Drafter Initials	Apprv'd Date	Engineer Initials
C	MADE FPD	8/11/16	SML		
B	REV. PER MARKUPS	07/11/16	CJS	07/19/16	AZB
A	MADE SHOPS/APPLIED SCAN	07/11/16	GAW	07/19/16	AZB

<b>OREGON STATE UNIVERSITY</b>					
<b>CORVALLIS, OR</b>					
ELEVATION		DWG. NO. FPD			
SCALE: 3/8" = 1'	DATE	PRJ. NO.	F161238		
DRAWN BY: CJS	6/14/16	SHEET	OF	REV. NO.	
CHECKED BY: AZB	6/16/16	4	6	C	

ALTHOUGH BUILDING CODES HAVE BEEN CONSIDERED IN DEVELOPING THIS SEATING PLAN, VERIFICATION OF COMPLIANCE WITH BUILDING CODES IS THE EXCLUSIVE RESPONSIBILITY OF THE CUSTOMER AND/OR ARCHITECT.

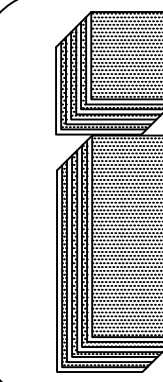

**Irwin  
Seating  
Company**

TELESCOPIC DIVISION

US ROUTE 40 EAST  
PO BOX 320  
ALTAMONT, IL 62411

Toll Free: (877) 597-1122

Phone: (618) 483-6157

Fax: (618) 483-5539

www.irwinseating.com

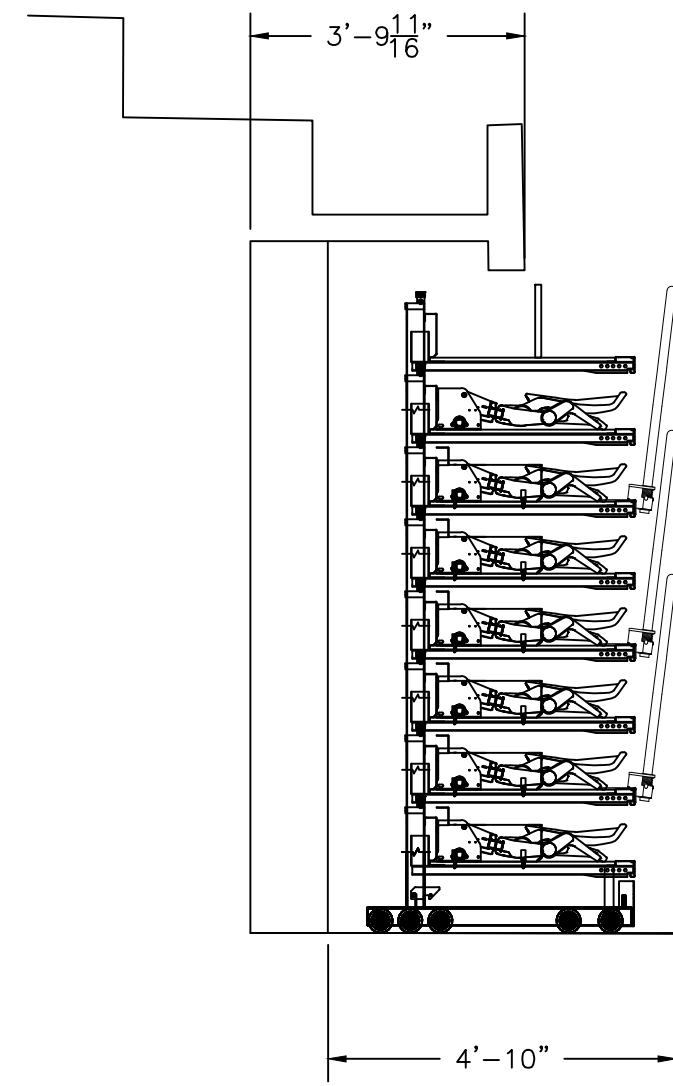

A  
5

7 ROW INTEGRA SIDELINE ELEVATION CLOSED  
SCALE: 3/8" = 1'-0"

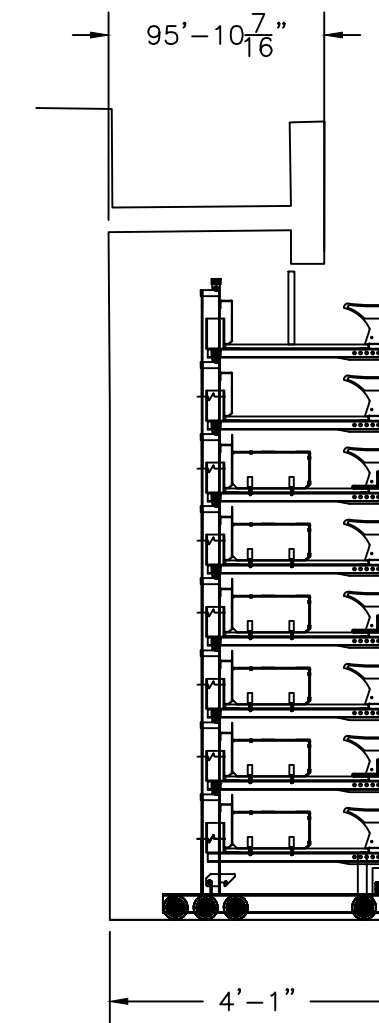

B  
5

8 ROW INFINITY SIDELINE ELEVATION CLOSED  
SCALE: 3/8" = 1'-0"

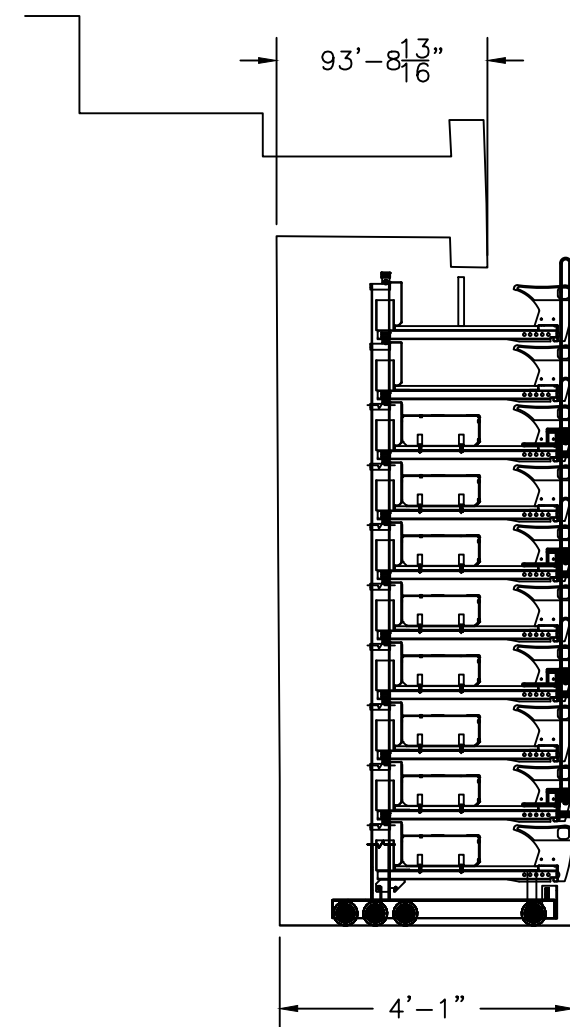

C  
5

10 ROW INFINITY ENDZONE ELEVATION CLOSED  
SCALE: 3/8" = 1'-0"

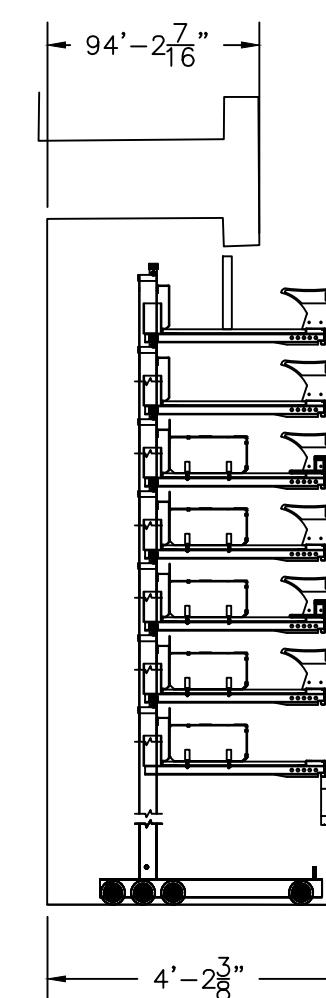

D  
5

6 ROW INFINITY ENDZONE ELEVATION CLOSED  
SCALE: 3/8" = 1'-0"

No.	Revision/Issue	Rev Date	Drafter Initials	Apprv'd Date	Engineer Initials
C	MADE FPD	8/11/16	SML		
B	REV. PER MARKUPS	07/11/16	CJS	07/19/16	AZB
A	MADE SHOPS/APPLIED SCAN	07/11/16	GAW	07/19/16	AZB

OREGON STATE UNIVERSITY

CORVALLIS, OR

ELEVATION	DWG. NO. FPD
SCALE: 3/8" = 1'	DATE
DRAWN BY: CJS	6/14/16
CHECKED BY: AZB	6/16/16
PRJ. NO. F161238	SHEET 5 OF 6
REV. NO. C	

ALTHOUGH BUILDING CODES HAVE BEEN CONSIDERED IN DEVELOPING THIS SEATING PLAN, VERIFICATION OF COMPLIANCE WITH BUILDING CODES IS THE EXCLUSIVE RESPONSIBILITY OF THE CUSTOMER AND/OR ARCHITECT.

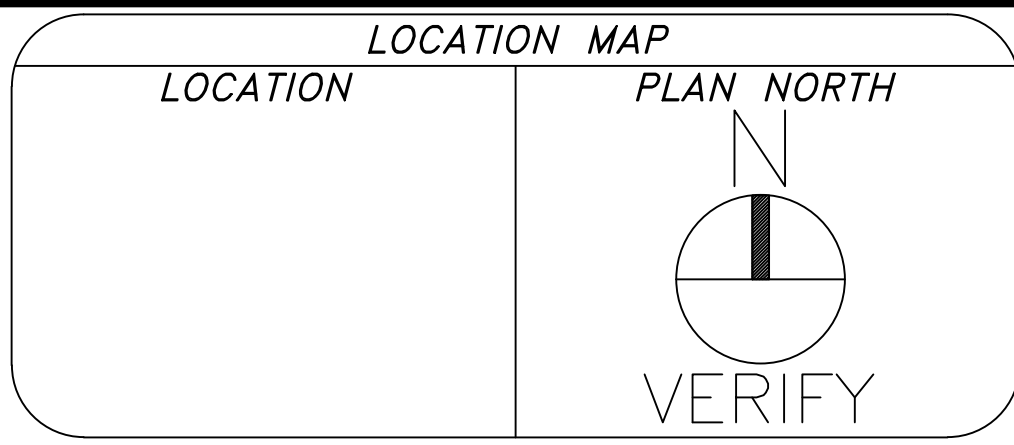

**Irwin Seating Company**  
TELESCOPIC DIVISION  
US ROUTE 40 EAST  
PO BOX 320  
ALTAMONT, IL 62411  
Toll Free: (877) 597-1122  
Phone: (618) 483-6157  
Fax: (618) 483-5539  
www.irwinseating.com

REQUIREMENTS:  
MODEL 4500  
SHIPPING KD

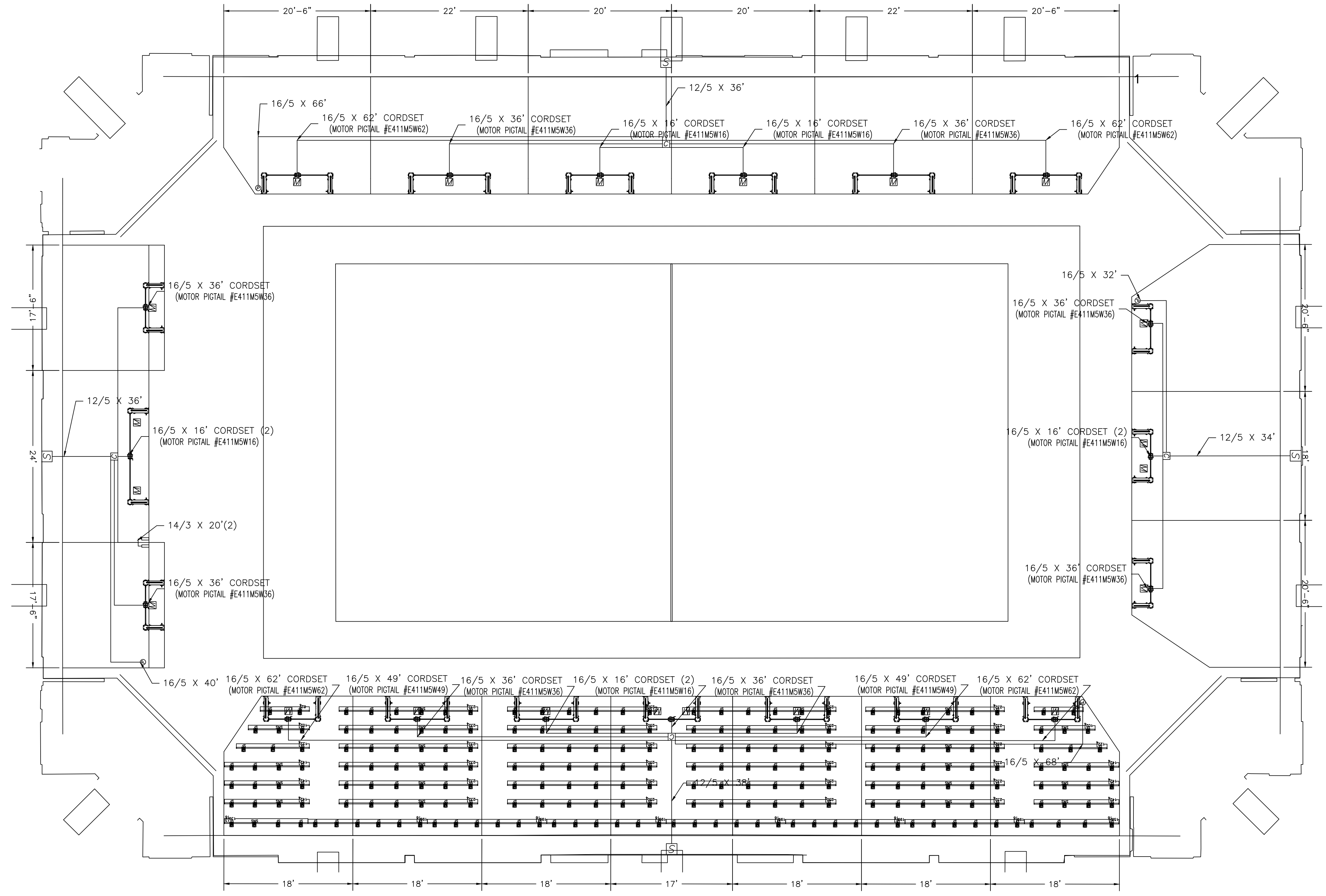

**NOTE:**  
Readily accessible disconnection box and wiring (as required by NEC) supplied and located by others.  
UL 489 branch circuit protective devices to be provided by others per NEC and UL 588 per the others listed below.  
(a) If the branch protection is a breaker 250% of the largest motor FLA plus the sum of the remaining motor loads.  
(b) If the branch protection is a time delay fuse 175% of the largest motor FLA plus the sum of the remaining motor loads.  
(c) If the branch protection is a GFI 200% of the largest motor FLA plus the sum of the remaining motor loads.

**Branch Circuit Protection Requirements (NEC Table 430.52 & Section 430.62)**

MOTOR TYPE	Motor FLA	amps per motor	motors	amp
2	1.8	1.8	2.2	2.2
	1.8 amps x 2.2 motors = 3.96	1.8 amps x 2.2 motors = 3.96		
	1.8 amps x 2.2 motors = 3.96	1.8 amps x 2.2 motors = 3.96		
	1.8 amps x 2.2 motors = 3.96	1.8 amps x 2.2 motors = 3.96		

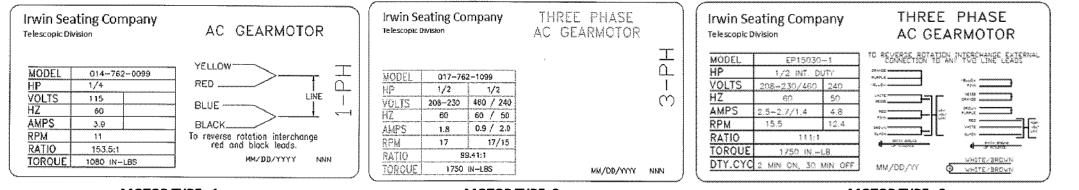

**NOTE:**  
Readily accessible disconnection box and wiring (as required by NEC) supplied and located by others.  
UL 489 branch circuit protective devices to be provided by others per NEC and UL 588 per the others listed below.  
(a) If the branch protection is a breaker 250% of the largest motor FLA plus the sum of the remaining motor loads.  
(b) If the branch protection is a time delay fuse 175% of the largest motor FLA plus the sum of the remaining motor loads.  
(c) If the branch protection is a GFI 200% of the largest motor FLA plus the sum of the remaining motor loads.

**Branch Circuit Protection Requirements (NEC Table 430.52 & Section 430.62)**

MOTOR TYPE	Motor FLA	amps per motor	motors	amp
2	1.8	1.8	12.2	12.2
	1.8 amps x 12.2 motors = 21.96	1.8 amps x 12.2 motors = 21.96		
	1.8 amps x 12.2 motors = 21.96	1.8 amps x 12.2 motors = 21.96		
	1.8 amps x 12.2 motors = 21.96	1.8 amps x 12.2 motors = 21.96		

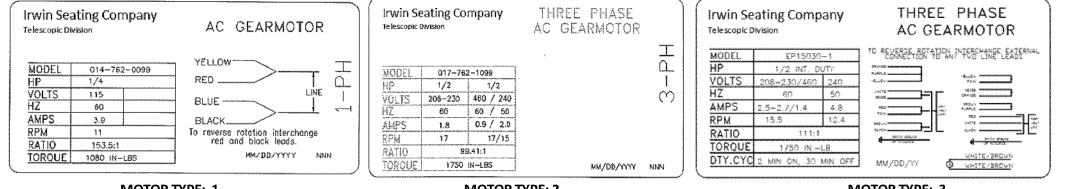

**NOTE:**  
Readily accessible disconnection box and wiring (as required by NEC) supplied and located by others.  
UL 489 branch circuit protective devices to be provided by others per NEC and UL 588 per the others listed below.  
(a) If the branch protection is a breaker 250% of the largest motor FLA plus the sum of the remaining motor loads.  
(b) If the branch protection is a time delay fuse 175% of the largest motor FLA plus the sum of the remaining motor loads.  
(c) If the branch protection is a GFI 200% of the largest motor FLA plus the sum of the remaining motor loads.

**Branch Circuit Protection Requirements (NEC Table 430.52 & Section 430.62)**

MOTOR TYPE	Motor FLA	amps per motor	motors	amp
2	1.8	1.8	15.8	15.8
	1.8 amps x 15.8 motors = 28.44	1.8 amps x 15.8 motors = 28.44		
	1.8 amps x 15.8 motors = 28.44	1.8 amps x 15.8 motors = 28.44		
	1.8 amps x 15.8 motors = 28.44	1.8 amps x 15.8 motors = 28.44		

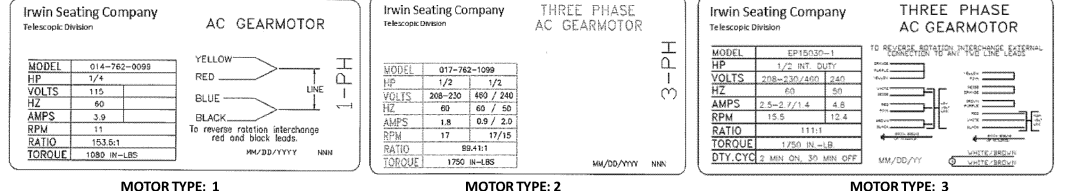

**POWER REQUIREMENTS**  
**NOTE:** Readily accessible disconnection box and wiring (as required by N.E.C.) supplied and located by others.

**Power Source** Voltage: 208-230 VAC Phase: Three  
Amp: 20 Freq: 60 Hz  
Notes: 5 wire (3 Power, Neutral & Ground)

**NOTE:** 4'-0" A.F.F. Max for 6 Rows and above Source Location  
2'-0" A.F.F. Max for 5 Rows and Below Source Location

**Aisle Lights** Voltage: 120 VAC Phase: 1  
Amp: 15 Freq: 60 Hz  
Notes: 120/24 Transformer by IISC

M Motor P Pendant C Contactor T Transformer  
K Key Switch Alarm Limit Switches

No.	Revision/Issue	Rev Date	Drafter Initials	Appr'd Date	Engineer Initials
C	MADE FPD	8/11/16	SML		
B	REV. PER MARKUPS	07/11/16	CJS	07/19/16	AZB
A	MADE SHOPS/APPLIED SCAN	07/11/16	GAW	07/19/16	AZB

**OREGON STATE UNIVERSITY**  
**CORVALLIS, OR**

ELECTRICAL	DWG. NO. FPD
SCALE: 1/8" = 1'	DATE: 6/14/16
DRAWN BY: CJS	PRJ. NO. F161238
CHECKED BY: AZB	SHEET 6 OF 6
	REV. NO. C

A  
6  
ELECTRICAL LAYOUT  
SCALE: 1/8" = 1'-0"

ALTHOUGH BUILDING CODES HAVE BEEN CONSIDERED IN DEVELOPING THIS SEATING PLAN, VERIFICATION OF COMPLIANCE WITH BUILDING CODES IS THE EXCLUSIVE RESPONSIBILITY OF THE CUSTOMER AND/OR ARCHITECT.