

DRAWN BY:
LRR
DATE:
7/2011

SUB-BASEMENT FLOOR PLAN (NORTH)
SCIENCE RESEARCH AND TEACHING CENTER
1719 S.W. 10TH

FACILITIES
617 SOUTHWEST
MONTGOMERY STREET
PORTLAND, OR. 97201
www.fac.pdx.edu
TEL: 503-725-3738
FAX: 503-725-4329

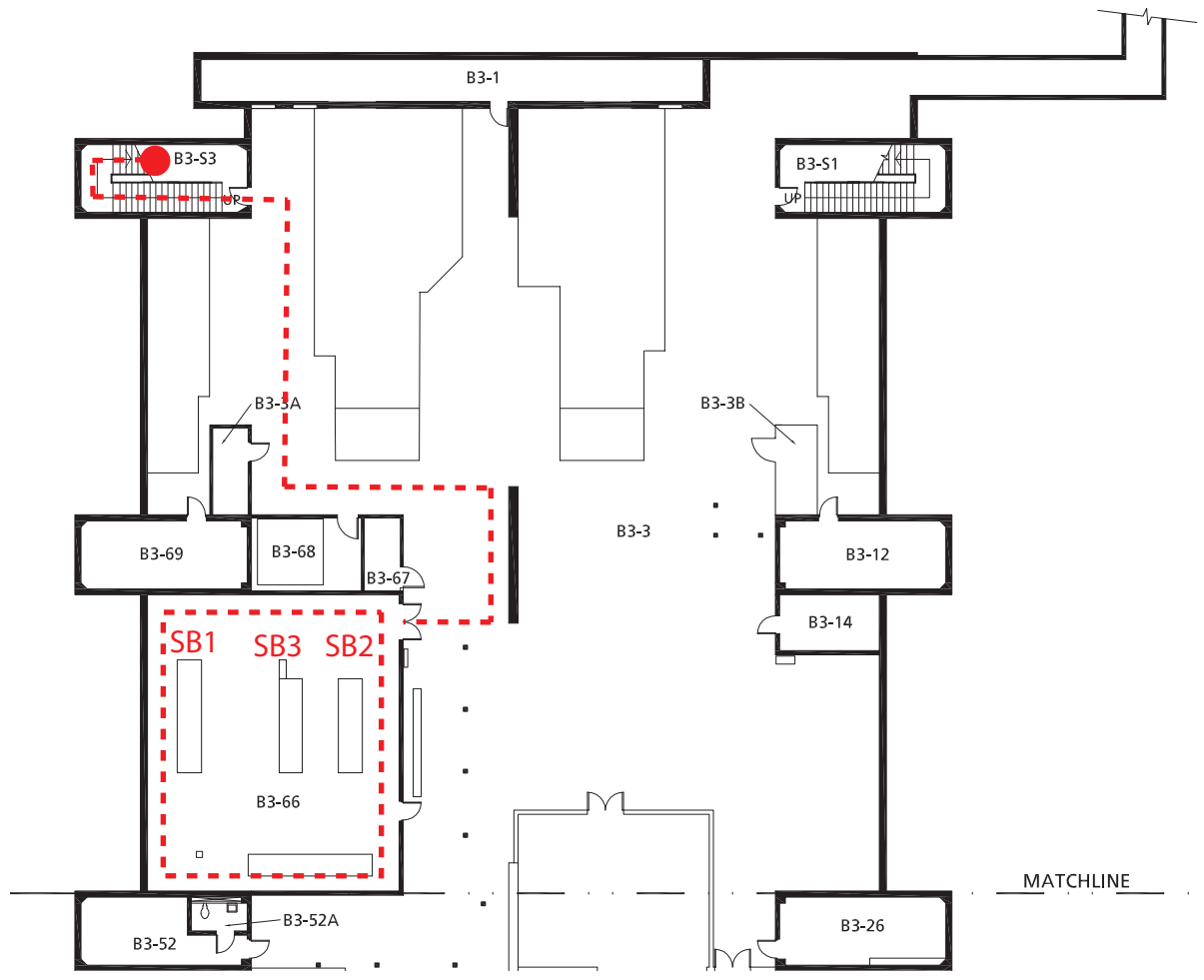

Generator placement is on the North side of building, see dwg A3.1 (1e).
It can be fed through stairwell at basement level to the sub-basement. Gear is in room B3-66. Three locations need to be powered SB1, SB2, and SB3

MATCHLINE NORTH SOUTH

SUB-BASEMENT FLOOR PLAN (NORTH)

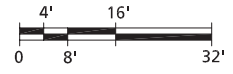

1a

Critical Bldg



241 - A1.2

DRAWN BY:
LRR
DATE:
7/2011

SUB-BASEMENT FLOOR PLAN (SOUTH)
SCIENCE RESEARCH AND TEACHING CENTER
1719 S.W. 10TH

FACILITIES
617 SOUTHWEST
MONTGOMERY STREET
PORTLAND, OR. 97201
www.fac.pdx.edu
TEL: 503-725-3738
FAX: 503-725-4329

PORTLAND
STATE
UNIVERSITY

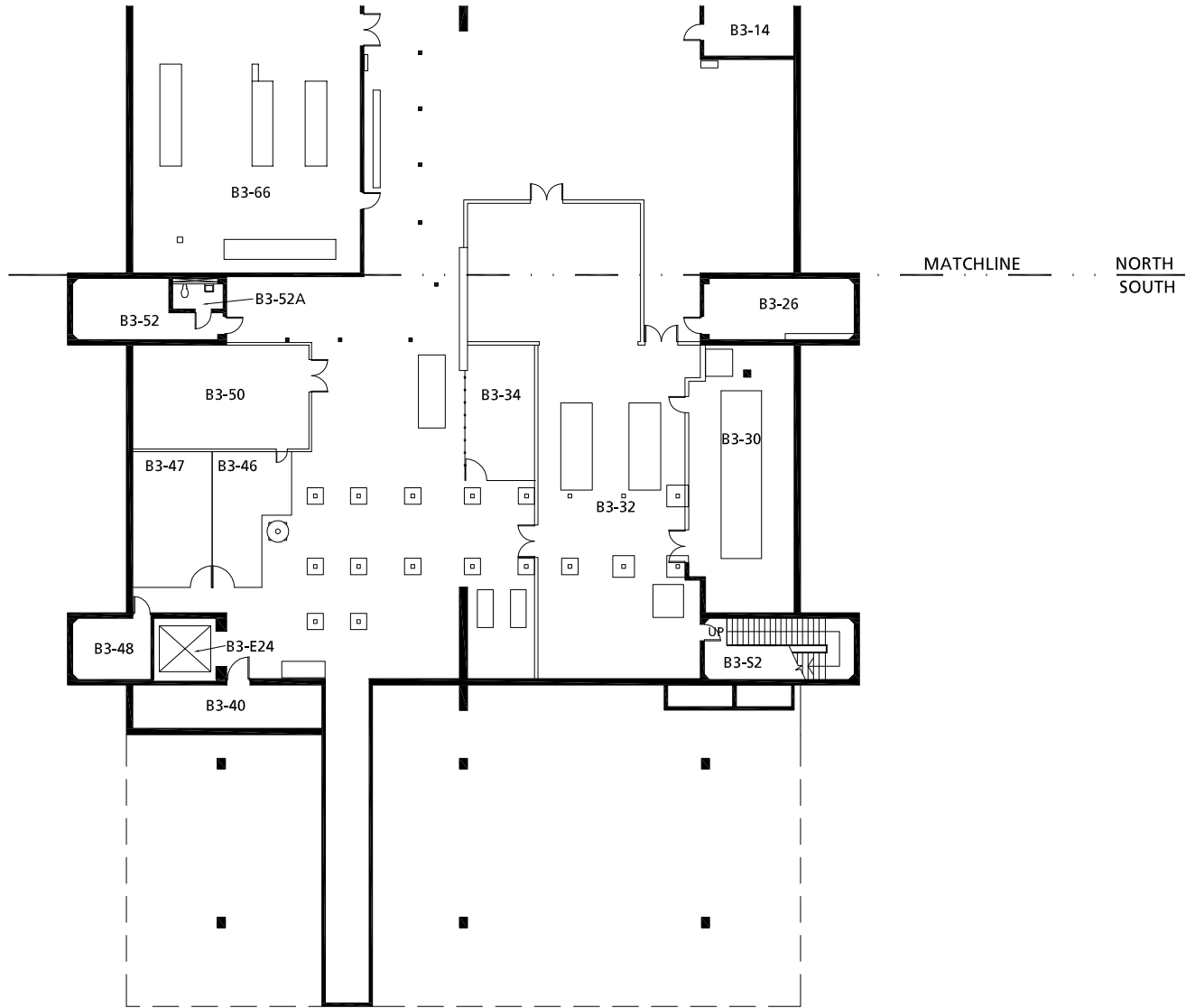

SUB-BASEMENT FLOOR PLAN (SOUTH)

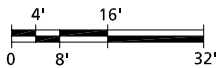

1b

Critical Bldg



SUB-BASEMENT FLOOR PLAN

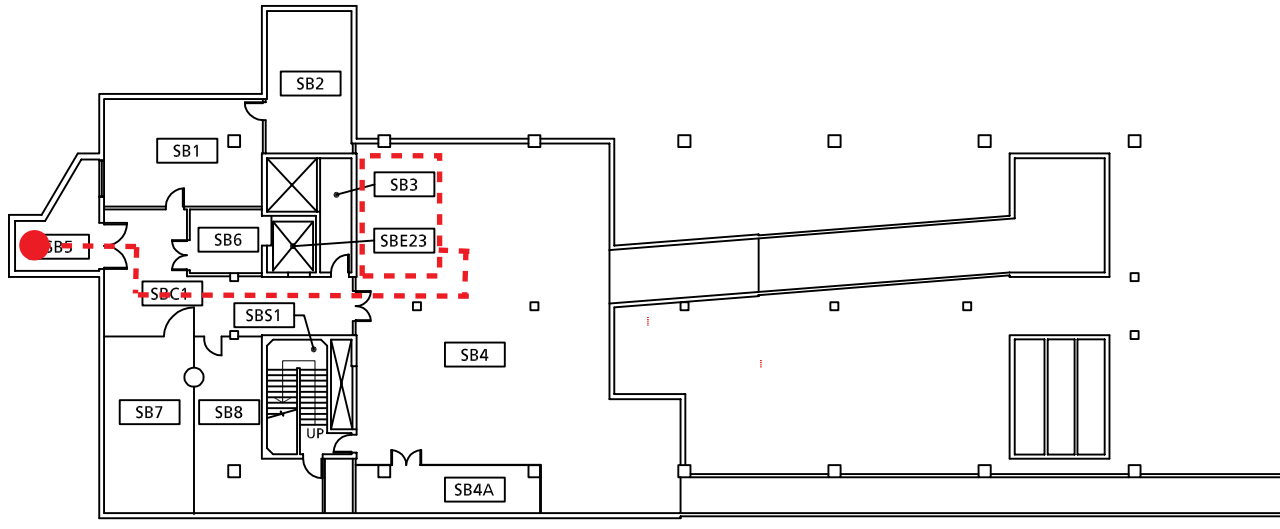
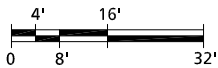

Generator placement can be the same place as SRTC or more north to be closer to SB1. There is a hatch leading to the sub-basement in front of the West entrance.

2a

Critical bldg



FACILITIES
617 SOUTHWEST
MONTGOMERY STREET
PORTLAND, OR. 97201
www.fac.pdx.edu
TEL: 503-725-3738
FAX: 503-725-4329

SUB-BASEMENT FLOOR PLAN
SCIENCE BUILDING ONE
1025 S.W. MILL

DRAWN BY:
LRR
DATE:
10/01/2003

242 - A1

PORTLAND
STATE
UNIVERSITY

242 - A2

DRAWN BY:
LRR

DATE:
2/2012

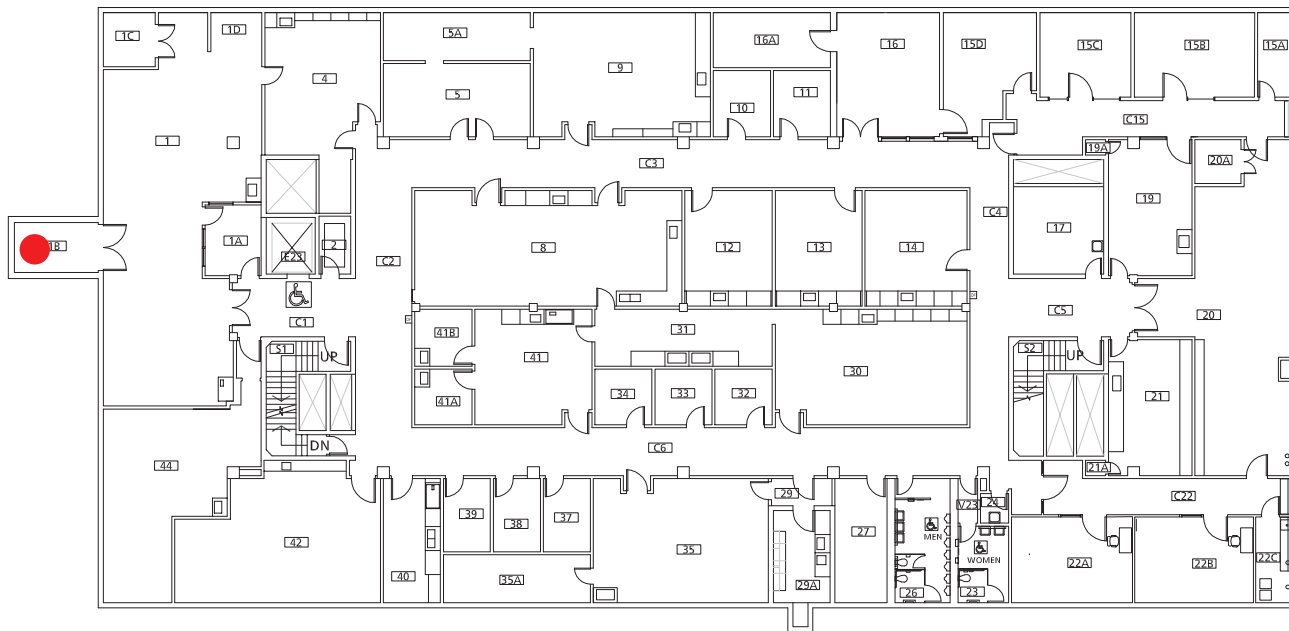

BASEMENT FLOOR PLAN
SCIENCE BUILDING ONE
1025 S.W. MILL

FACILITIES
617 SOUTHWEST
MONTGOMERY STREET
PORTLAND, OR. 97201
www.fac.pdx.edu
TEL: 503-725-3738
FAX: 503-725-4329

PORTLAND
STATE
UNIVERSITY

BASEMENT FLOOR PLAN

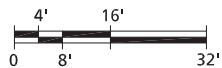

2b

Critical bldg



242 - A3

DRAWN BY:
LRR

DATE:
6/7/2005

FIRST FLOOR PLAN
SCIENCE BUILDING ONE
1025 S.W. MILL

FACILITIES
617 SOUTHWEST
MONTGOMERY STREET
PORTLAND, OR. 97201
www.fac.pdx.edu
TEL: 503-725-3738
FAX: 503-725-4329

PORTLAND
STATE
UNIVERSITY

hatch to
sub-basement

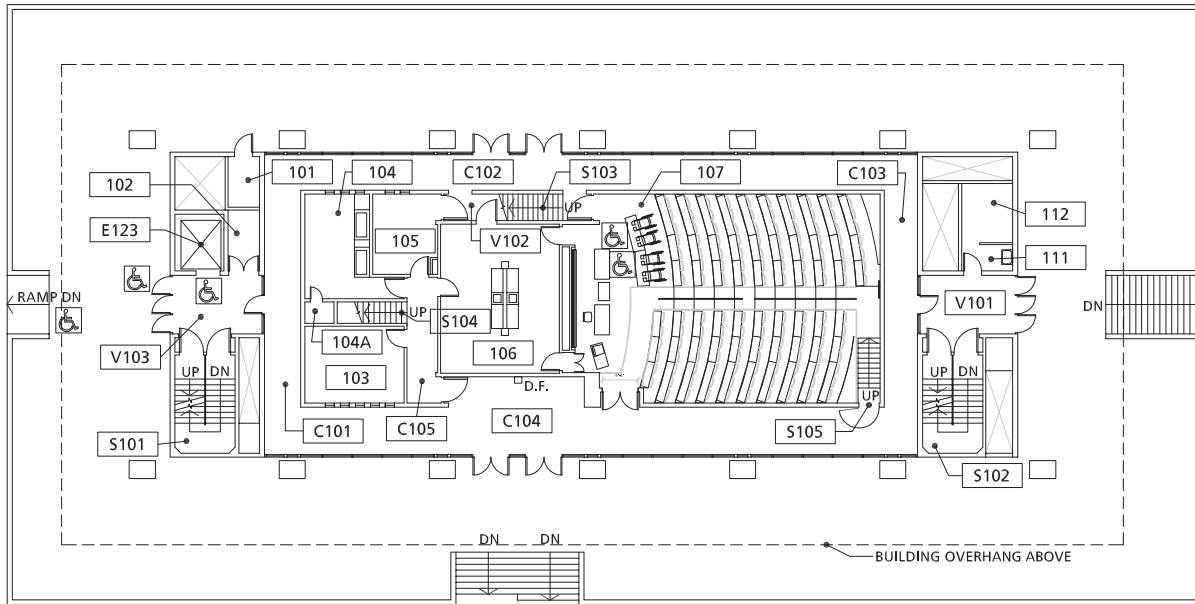

FIRST FLOOR PLAN

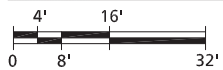

2c

Critical bldg



Generator placement is on West side of building. Fed through a stairwell to the tunnel system which leads to the gear in room 168. The tunnel continues to Millar Library. Millar can be fed through this same route. See its file for more details.

FIRST FLOOR PLAN (WEST)

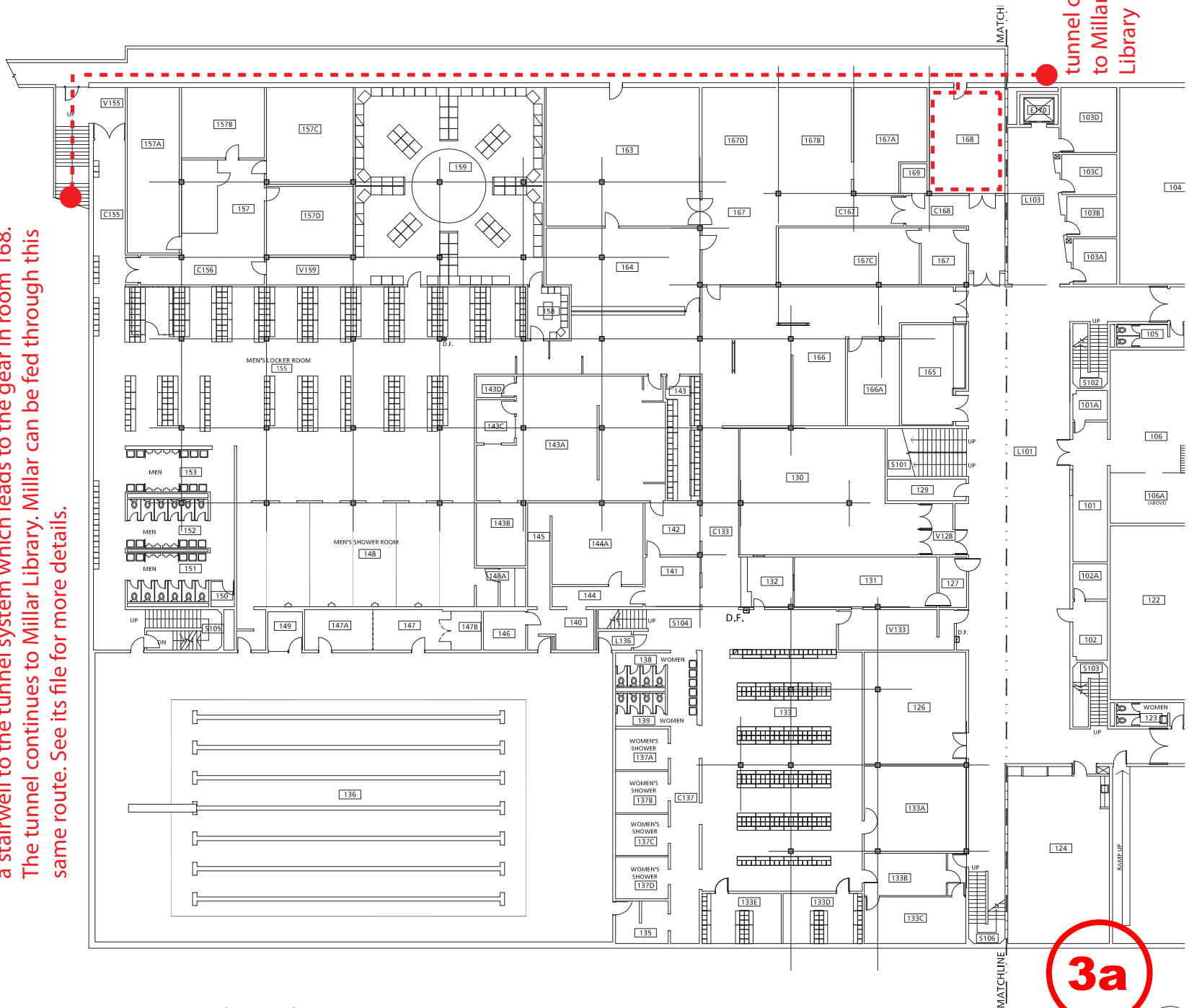
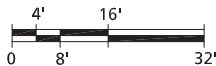

3a

Critical Bldg



tunnel cont.
to Millar
Library

Note: this will feed power the Research Green House too

231 - A2.1

DRAWN BY:
LRR
DATE:
12/2011

FIRST FLOOR PLAN (WEST)
PETER W. STOTT CENTER
930 S.W. HALL

FACILITIES
617 SOUTHWEST
MONTGOMERY STREET
PORTLAND, OR. 97201
www.fac.pdx.edu
TEL: 503-725-3738
FAX: 503-725-4329

PORTLAND
STATE
UNIVERSITY

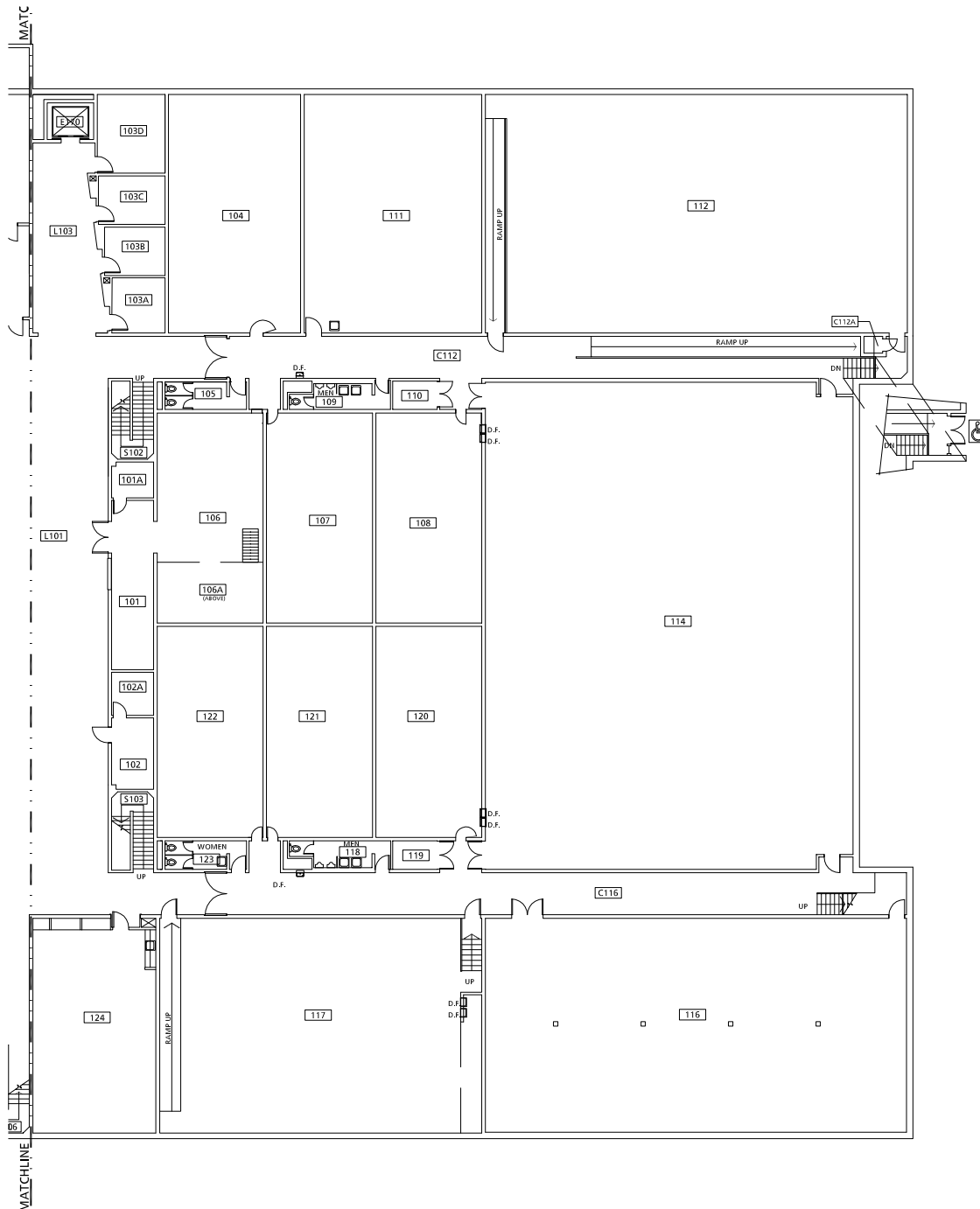

FIRST FLOOR PLAN (EAST)

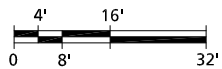

3b



Critical Bldg

231 - A2.2

DRAWN BY:
LRR
DATE:
8/2011

**FIRST FLOOR PLAN (EAST)
PETER W. STOTT CENTER
930 S.W. HALL**

FACILITIES
617 SOUTHWEST
MONTGOMERY STREET
PORTLAND, OR. 97201
www.fac.pdx.edu
TEL: 503-725-3738
FAX: 503-725-4329

**PORTLAND
STATE
UNIVERSITY**

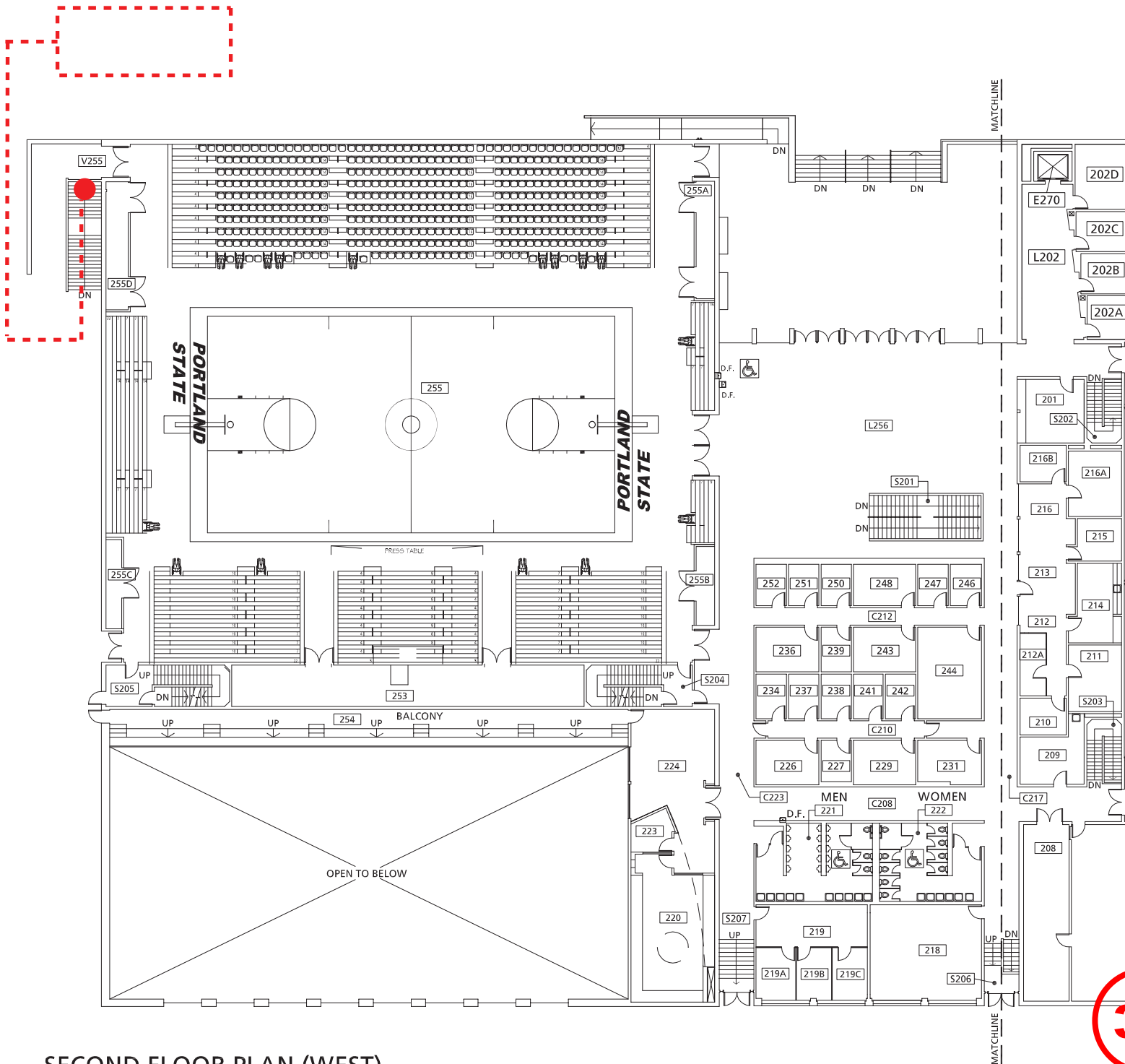

SECOND FLOOR PLAN (WEST)

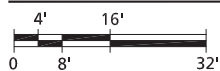

3c
Critical Bldg ↑

231 - A3.1

DRAWN BY:
 LRR
 DATE:
 8/2011

**SECOND FLOOR PLAN (WEST)
 PETER W. STOTT CENTER
 930 S.W. HALL**

FACILITIES
 617 SOUTHWEST
 MONTGOMERY STREET
 PORTLAND, OR. 97201
 www.fac.pdx.edu
 TEL: 503-725-3738
 FAX: 503-725-4329

**PORTLAND
 STATE
 UNIVERSITY**

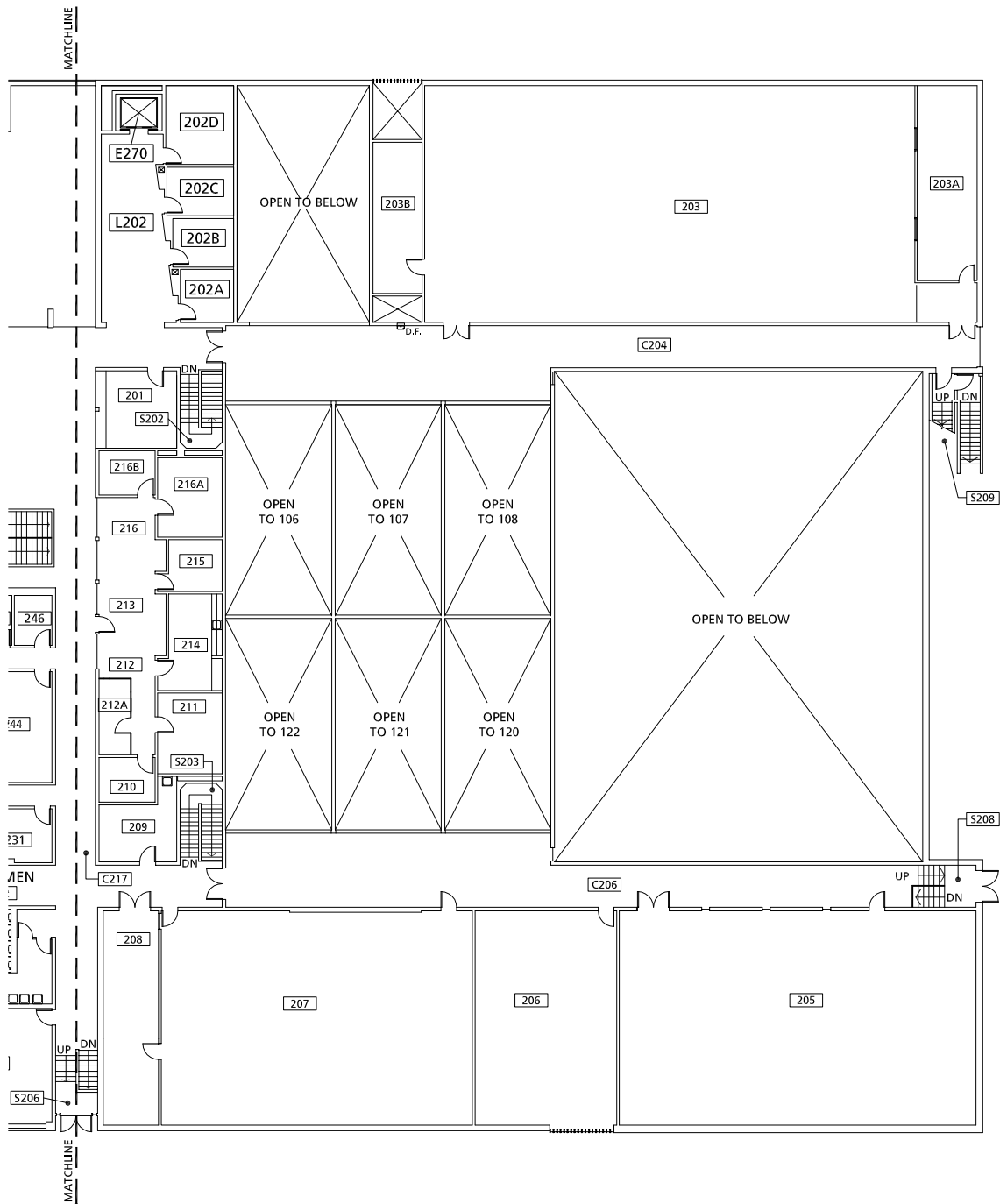

231 - A3.2

DRAWN BY:
LRR
DATE:
8/2011

SECOND FLOOR PLAN (EAST)
PETER W. STOTT CENTER
930 S.W. HALL

FACILITIES
617 SOUTHWEST
MONTGOMERY STREET
PORTLAND, OR. 97201
www.fac.pdx.edu
TEL: 503-725-3738
FAX: 503-725-4329

PORTLAND
STATE
UNIVERSITY

SECOND FLOOR PLAN (EAST)

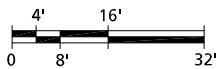

3d



Critical Bldg

DRAWN BY:
LRR
DATE:
9/29/2003

SUB - BASEMENT FLOOR PLAN
201, CRAMER HALL
1721 S.W. BROADWAY

FACILITIES
617 SOUTHWEST
MONTGOMERY STREET
PORTLAND, OR. 97201
www.fac.pdx.edu
TEL: 503-725-3738
FAX: 503-725-4329

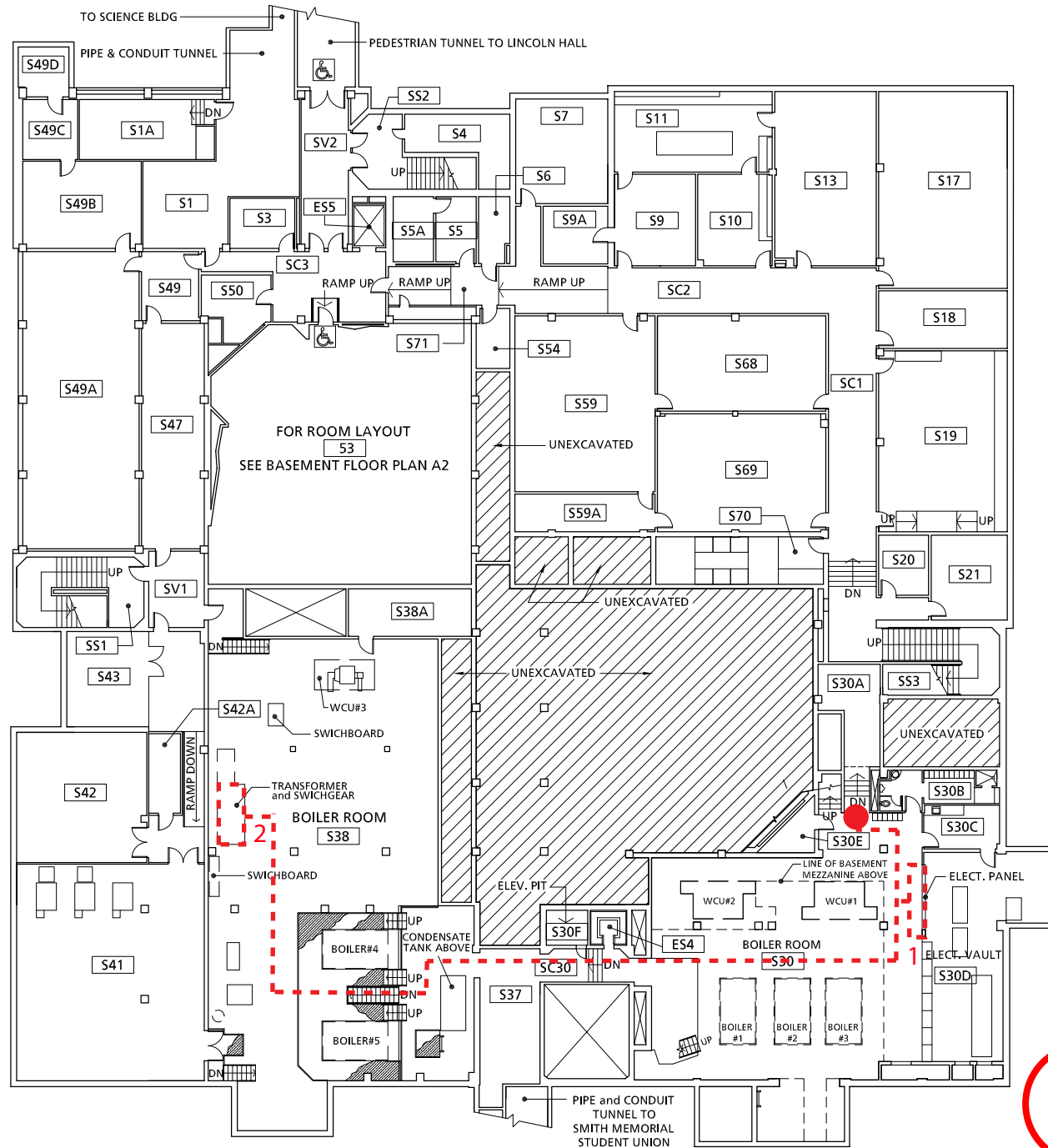

Generator placement is on SE side of building and fed through East doors down stairs to sub-basement. There are two panel areas that need to be fed (1) is Siemens/Boiler Controls, and Telecom (2) Boilers 4 & 5, and the Motor Control Center.

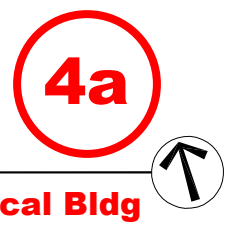

Critical Bldg

SUB - BASEMENT FLOOR PLAN

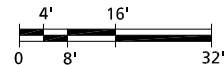

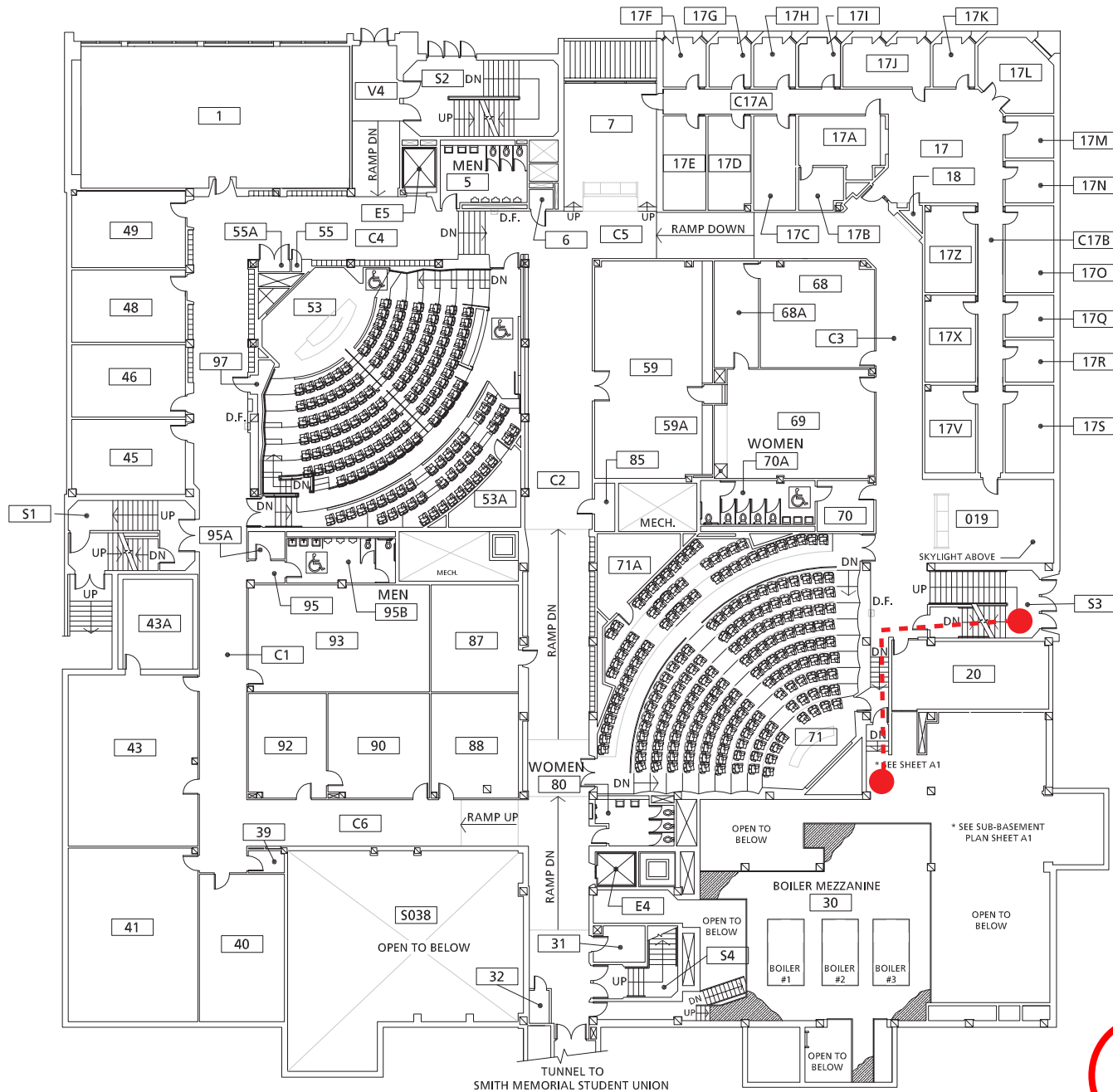

201 - A2

DRAWN BY:
LRR
DATE:
6/19/2007

BASEMENT FLOOR PLAN
201, CRAMER HALL
1721 S.W. BROADWAY

FACILITIES
617 SOUTHWEST
MONTGOMERY STREET
PORTLAND, OR. 97201
www.fac.pdx.edu
TEL: 503-725-3738
FAX: 503-725-4329

PORTLAND
STATE
UNIVERSITY

BASEMENT FLOOR PLAN

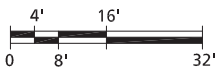

4b



Critical Bldg

201 - A3

DRAWN BY:
LRR
DATE:
1/2012

FIRST FLOOR PLAN
201, CRAMER HALL
1721 S.W. BROADWAY

FACILITIES
617 SOUTHWEST
MONTGOMERY STREET
PORTLAND, OR. 97201
www.fac.pdx.edu
TEL: 503-725-3738
FAX: 503-725-4329

PORTLAND
STATE
UNIVERSITY

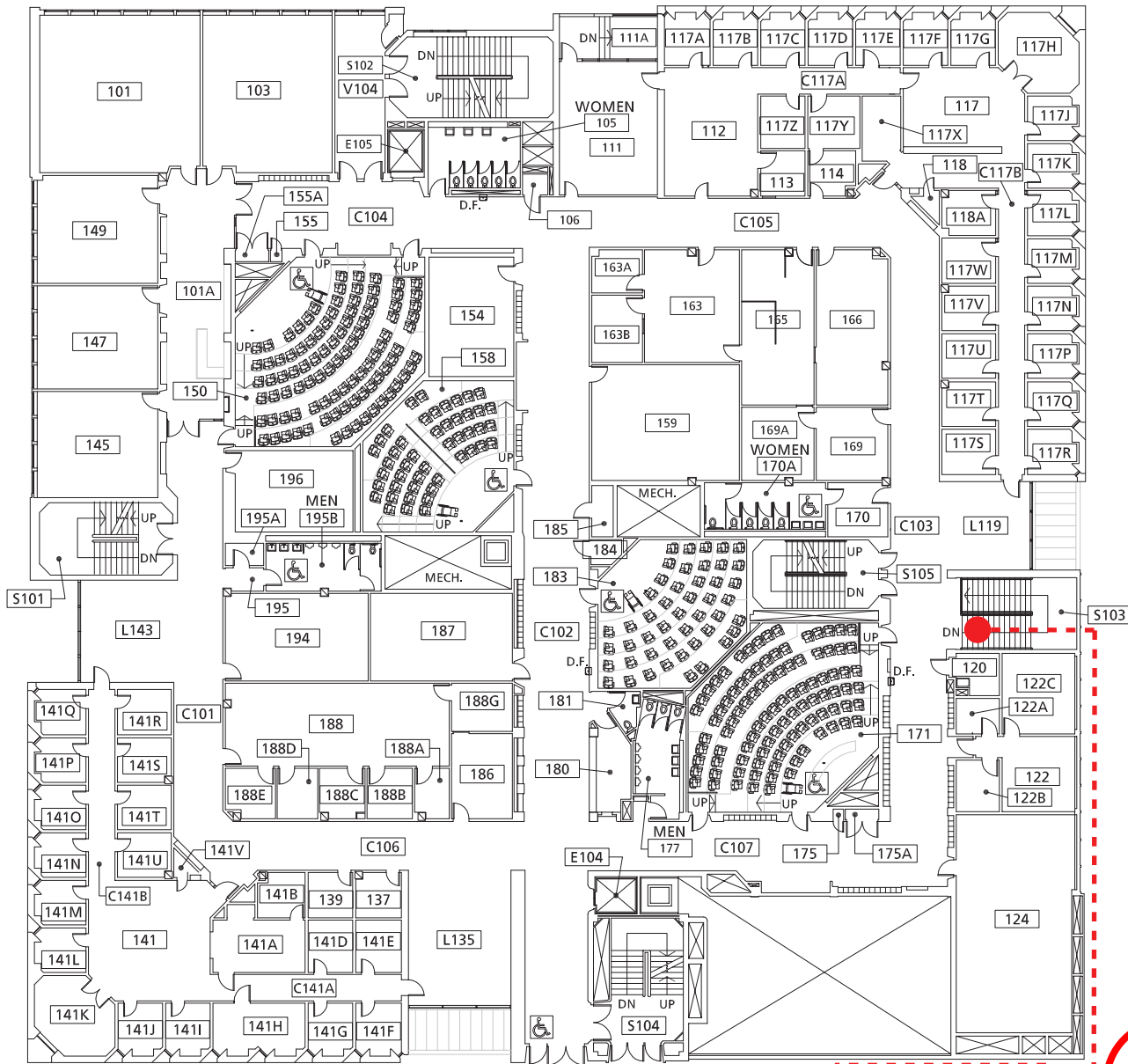

FIRST FLOOR PLAN

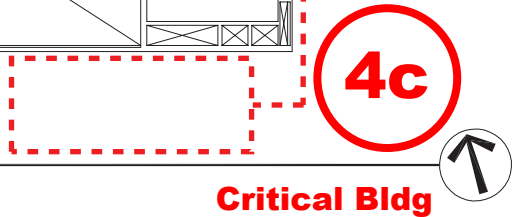
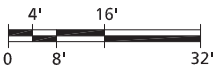

Critical Bldg

DRAWN BY:
LRR
DATE:
9/2011

BASEMENT FLOOR PLAN
200, SMITH MEMORIAL STUDENT UNION
1825 S.W. BROADWAY

FACILITIES
617 SOUTHWEST
MONTGOMERY STREET
PORTLAND, OR. 97201
www.fac.pdx.edu
TEL: 503-725-3738
FAX: 503-725-4329

Two Generators would be required for SMSU. One on the North and one on the South side. Each could be fed down stairs on the corresponding N and S entries to the gear. (1) South gear is non-priority. N gear at Location (2) feeds dining coolers. Alternatively, cable could be fed down hallway between gear rooms

LIBRARY EAST

LIBRARY EAST

SMITH MEMORIAL STUDENT UNION

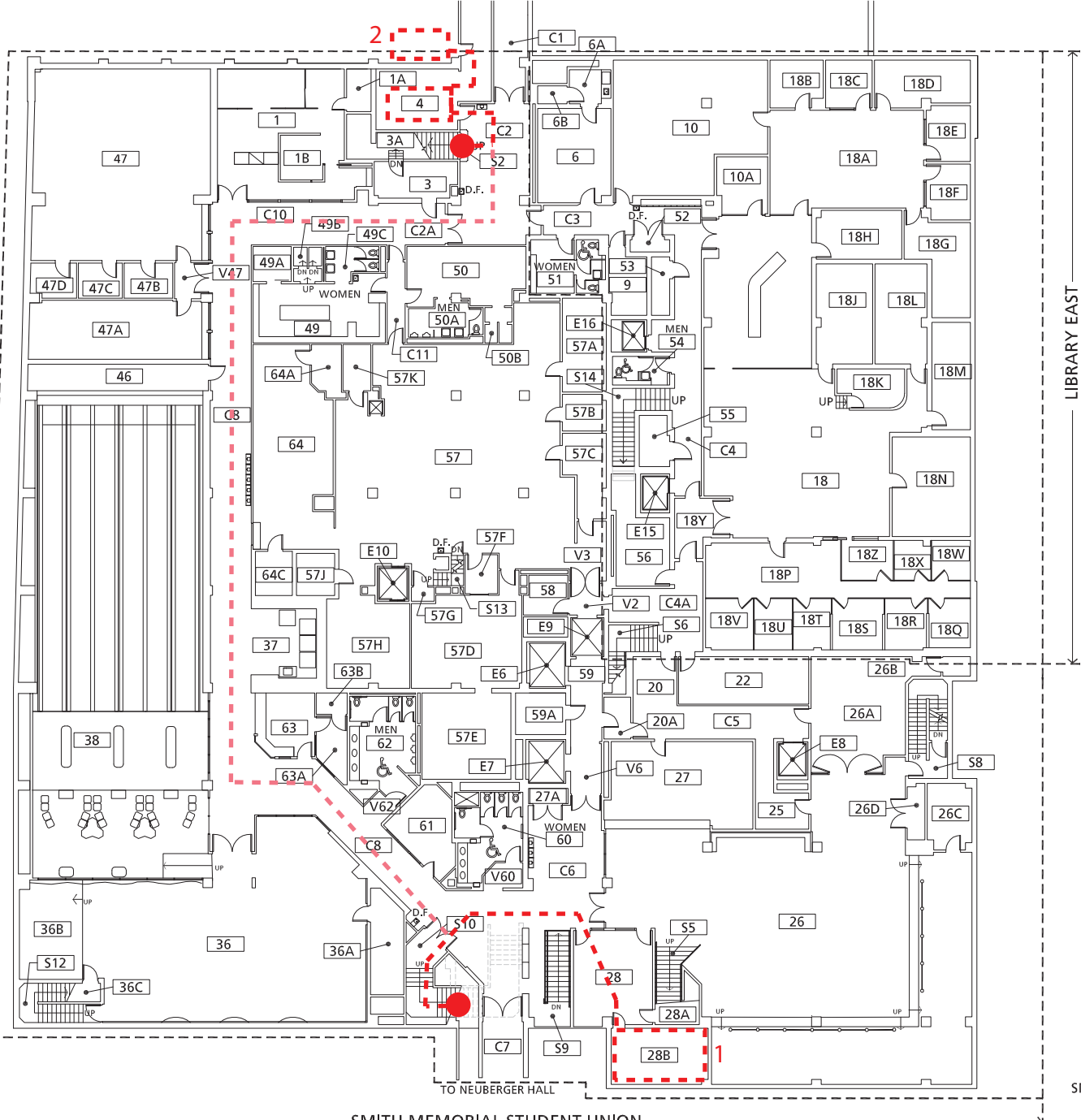

SMITH MEMORIAL STUDENT UNION

TO NEUBERGER HALL

BASEMENT FLOOR PLAN (SMSU)

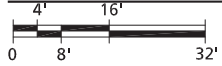

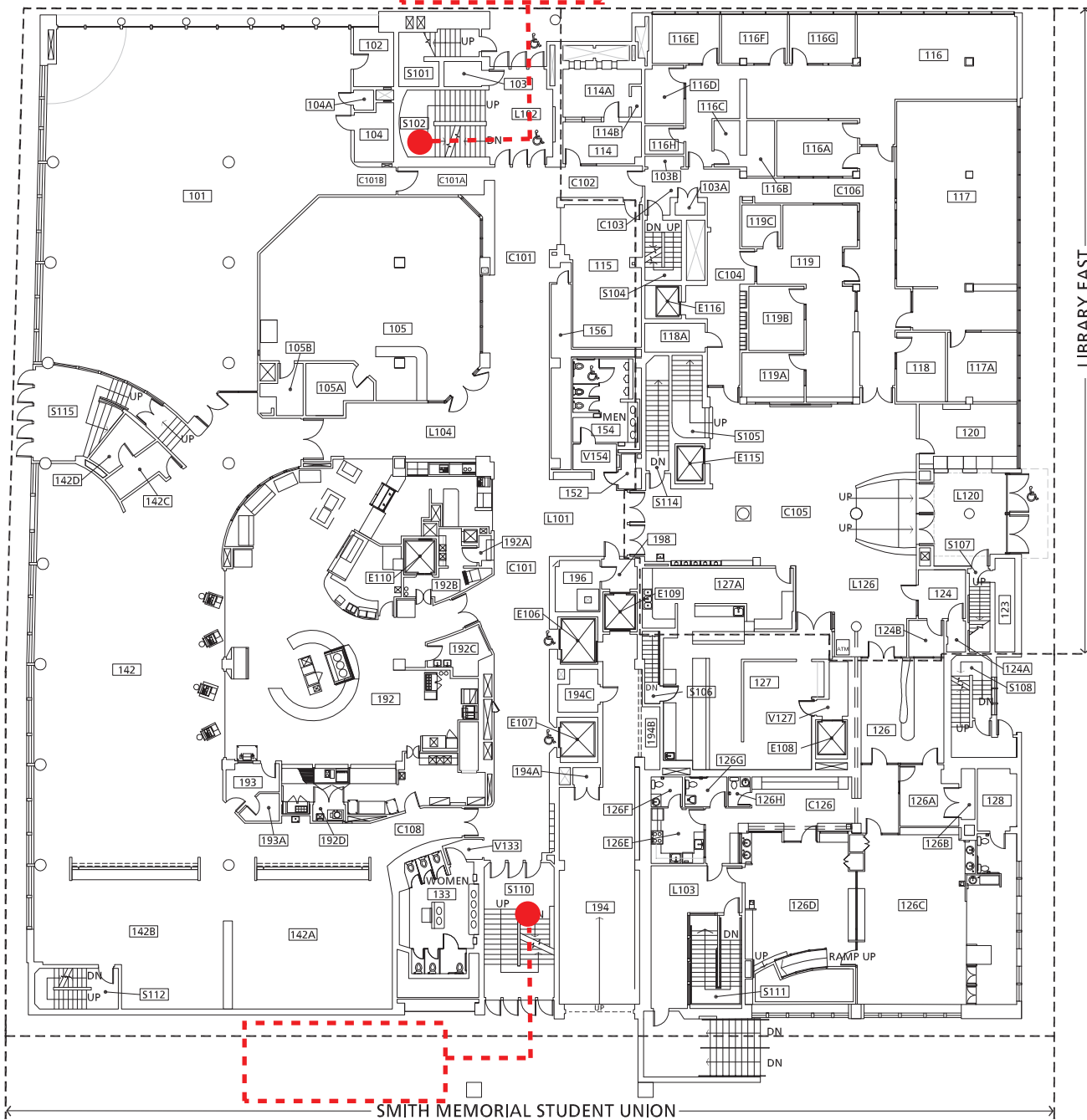

DRAWN BY:
LRR
DATE:
9/2011

FIRST FLOOR PLAN
200, SMITH MEMORIAL STUDENT UNION
1825 S.W. BROADWAY

FACILITIES
617 SOUTHWEST
MONTGOMERY STREET
PORTLAND, OR. 97201
www.fac.pdx.edu
TEL: 503-725-3738
FAX: 503-725-4329

PORTLAND
STATE
UNIVERSITY

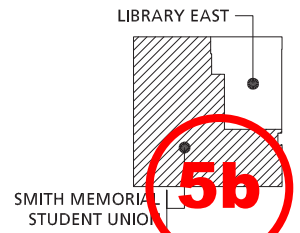

FIRST FLOOR PLAN (SMSU)

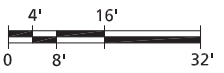

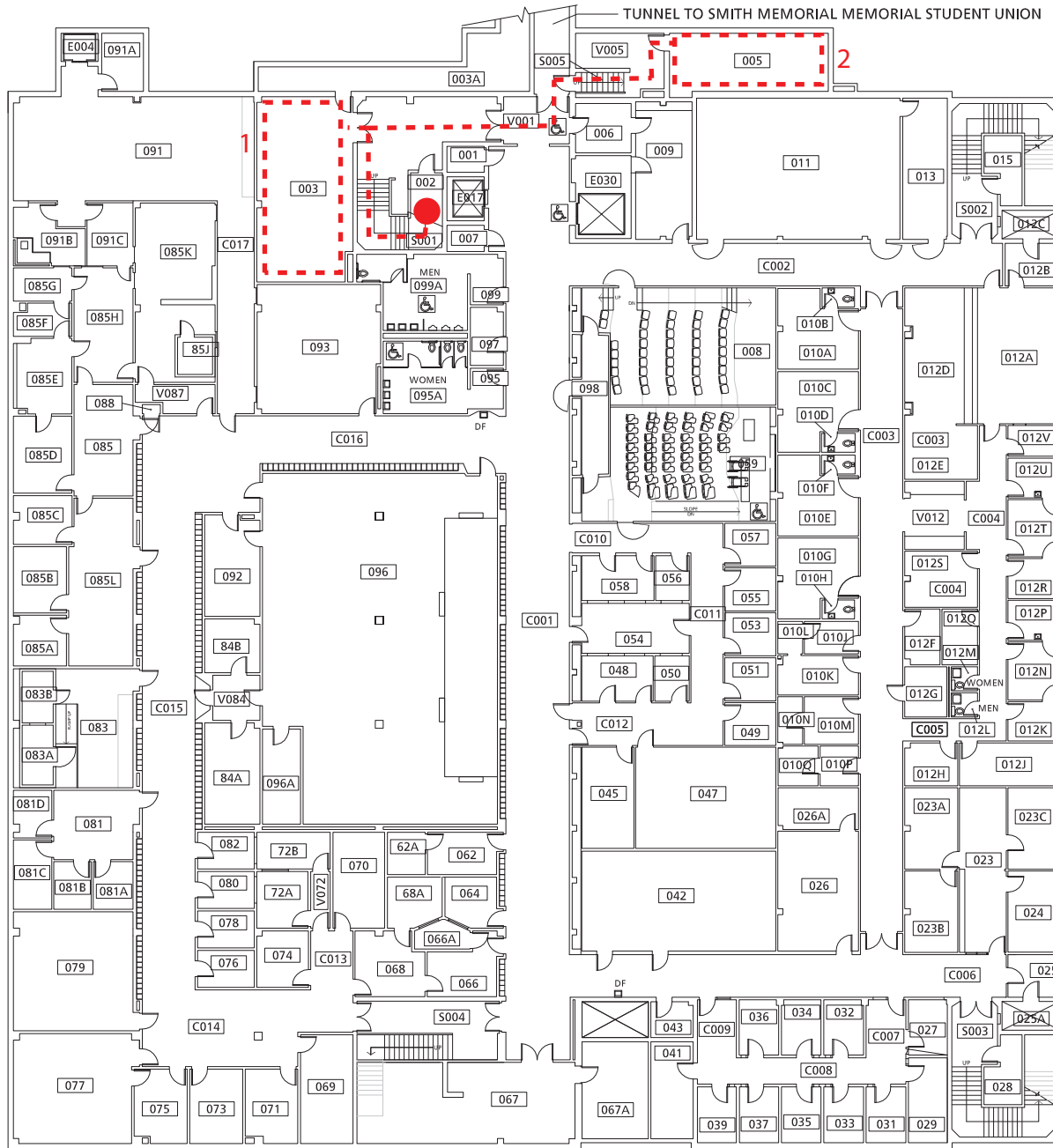

6a



BASEMENT FLOOR PLAN

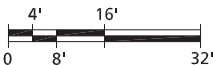

Generator placement is on the North side of the building. It can be fed down N stairwell to gear rooms (1) and (2). Neither room has more importance over the other.

199 - A1

DRAWN BY:
LRR
DATE:
2/2012

BASEMENT FLOOR PLAN
199, NEUBERGER HALL
724 S.W. HARRISON

FACILITIES
617 SOUTHWEST
MONTGOMERY STREET
PORTLAND, OR. 97201
www.fac.pdx.edu
TEL: 503-725-3738
FAX: 503-725-4329

PORTLAND
STATE
UNIVERSITY

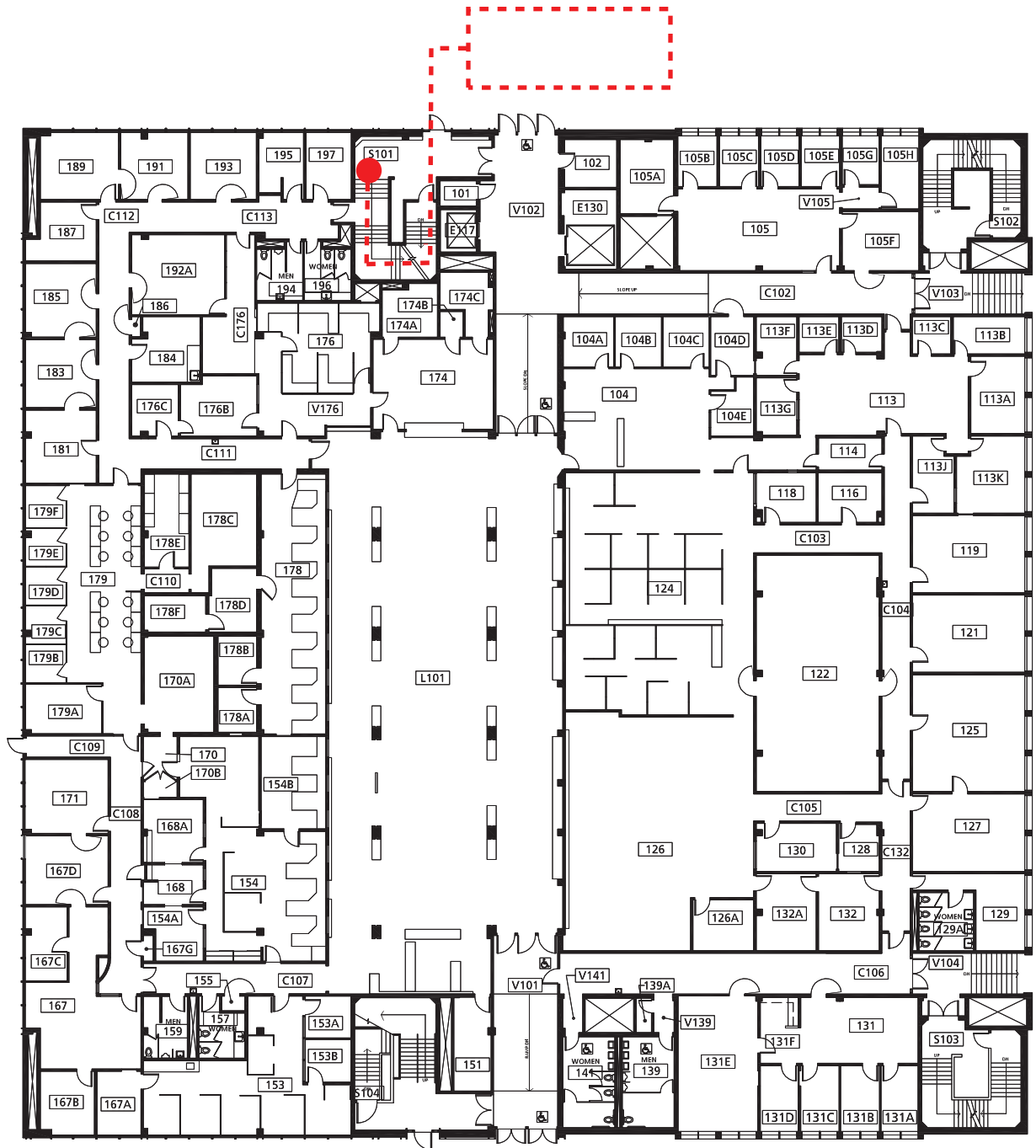

199 - A2

DRAWN BY:
LRR
DATE:
2/2012

FIRST FLOOR PLAN
199, NEUBERGER HALL
724 S.W. HARRISON

FACILITIES
617 SOUTHWEST
MONTGOMERY STREET
PORTLAND, OR. 97201
www.fac.pdx.edu
TEL: 503-725-3738
FAX: 503-725-4329

PORTLAND
STATE
UNIVERSITY

6b



FIRST FLOOR PLAN

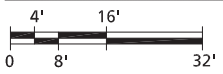

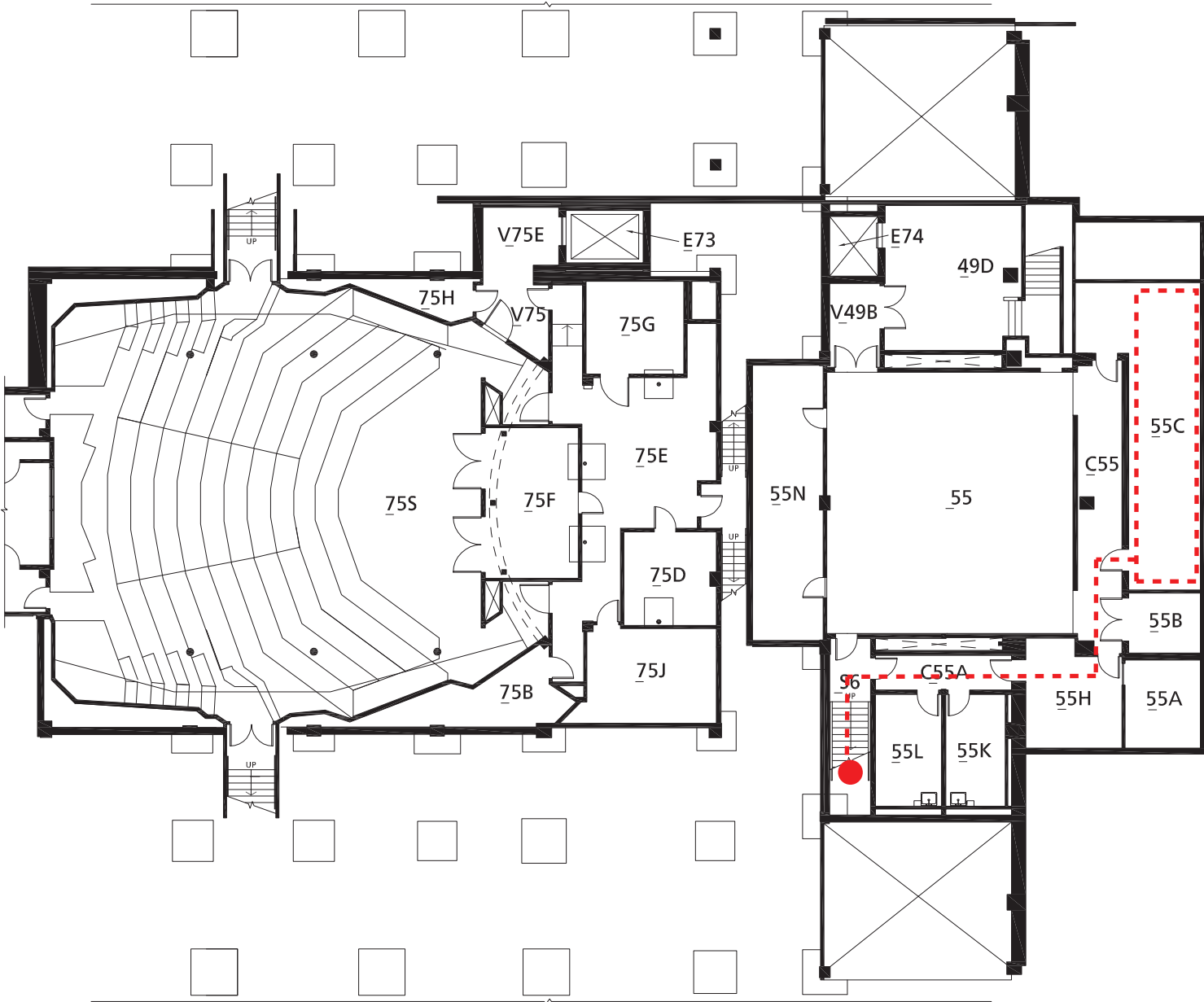

Generator placement in on SE corner of building. Cable can be fed through Floor-1 window or front door then down to the sub-basement.

SUB-BASEMENT FLOOR PLAN

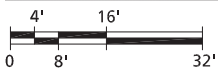

7a



202 - A0

DRAWN BY:
LRR
DATE:
1/2012

SUB-BASEMENT FLOOR PLAN
202, LINCOLN HALL
1620 S.W. PARK AVENUE

FACILITIES
617 SOUTHWEST
MONTGOMERY STREET
PORTLAND, OR. 97201
www.fac.pdx.edu
TEL: 503-725-3738
FAX: 503-725-4329

PORTLAND
STATE
UNIVERSITY

202 - A1

DRAWN BY:
LRR

DATE:
1/2012

BASEMENT FLOOR PLAN
202, LINCOLN HALL
1620 S.W. PARK AVENUE

FACILITIES
617 SOUTHWEST
MONTGOMERY STREET
PORTLAND, OR. 97201
www.fac.pdx.edu
TEL: 503-725-3738
FAX: 503-725-4329

PORTLAND
STATE
UNIVERSITY

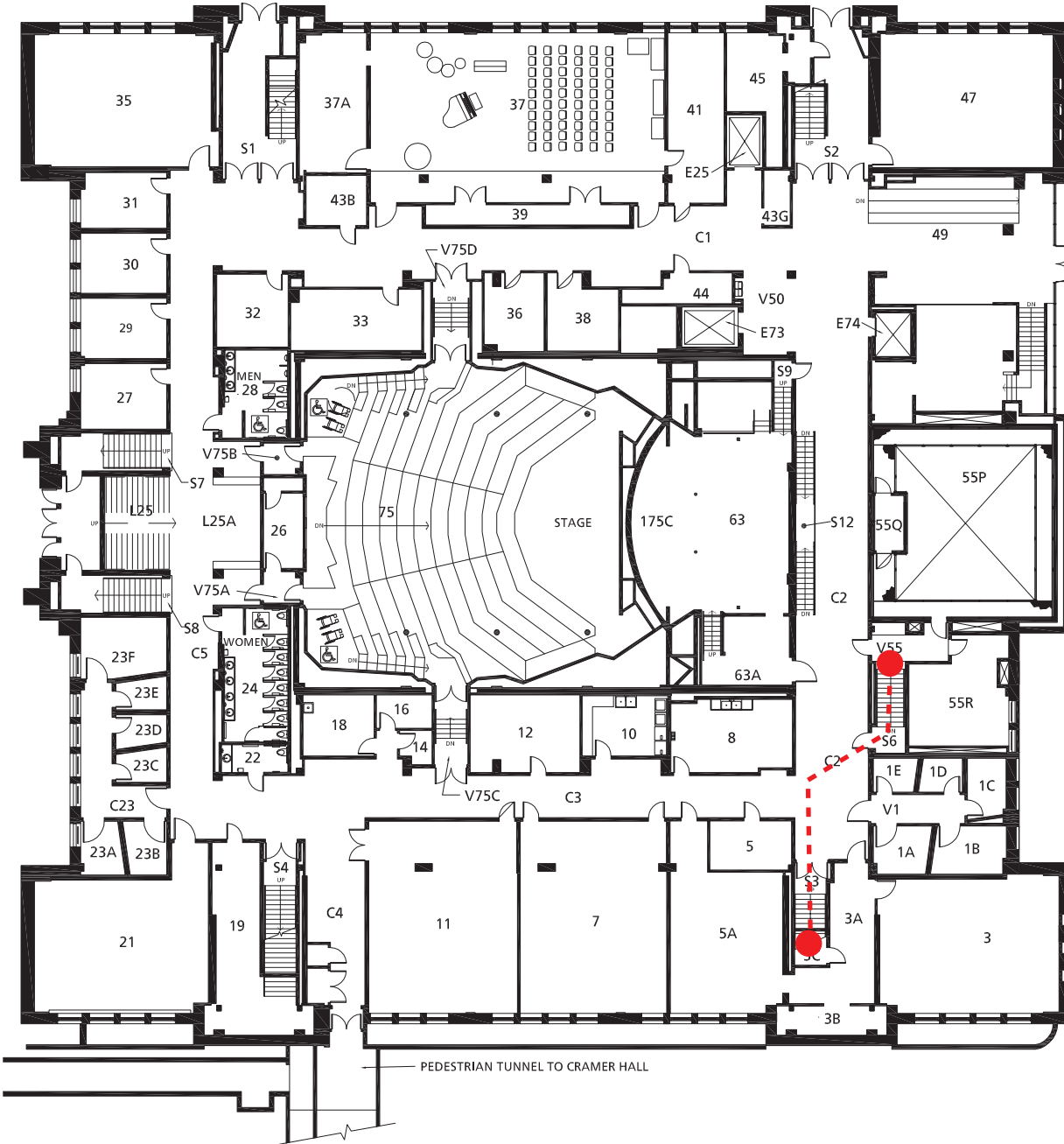

BASEMENT FLOOR PLAN

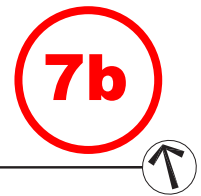
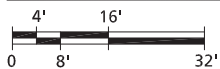

202 - A2

DRAWN BY:
LRR

DATE:
10/2011

FIRST FLOOR PLAN
202, LINCOLN HALL
1620 S.W. PARK AVENUE

FACILITIES
617 SOUTHWEST
MONTGOMERY STREET
PORTLAND, OR. 97201
www.fac.pdx.edu
TEL: 503-725-3738
FAX: 503-725-4329

PORTLAND
STATE
UNIVERSITY

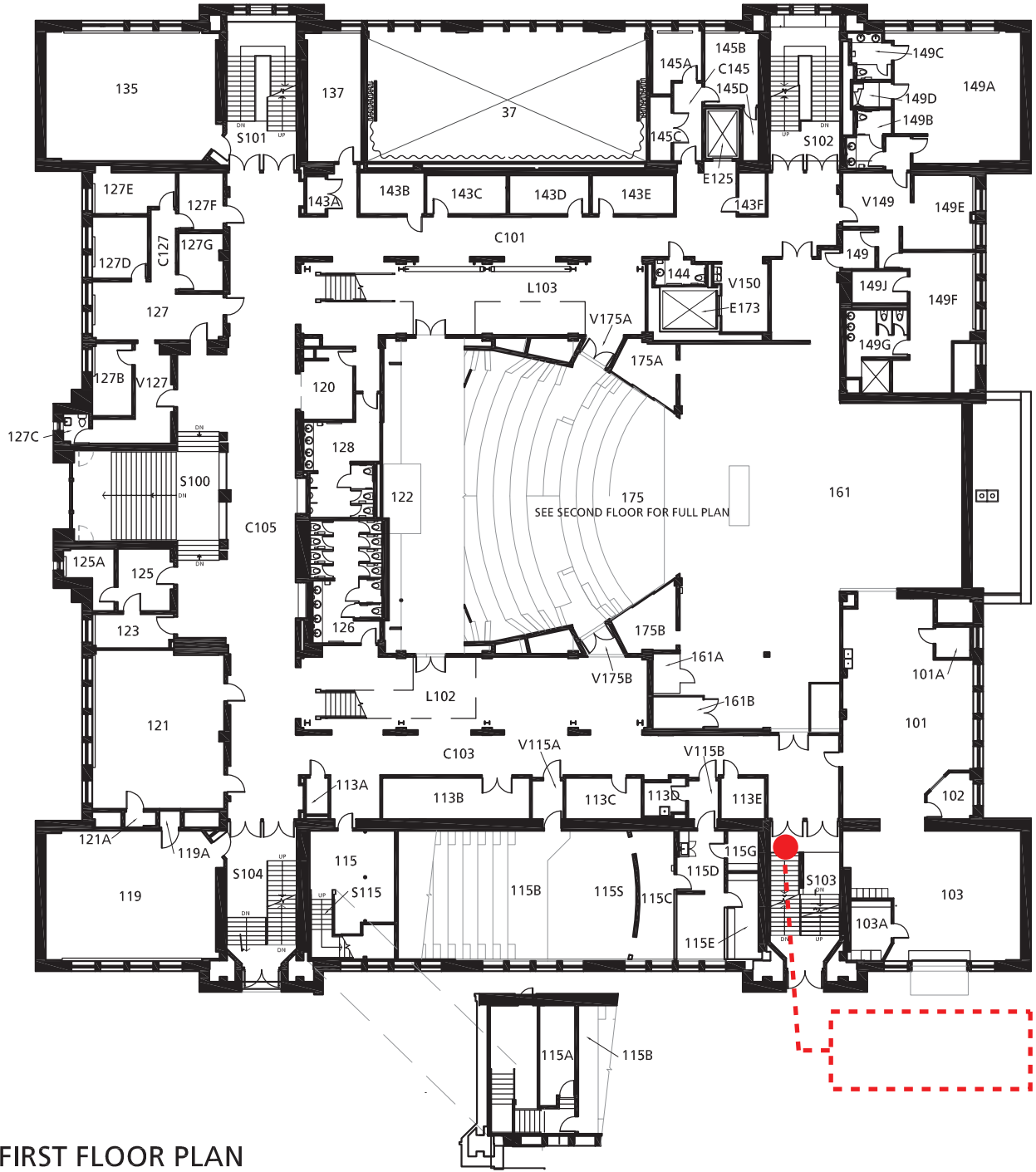

FIRST FLOOR PLAN

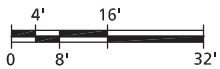

7c



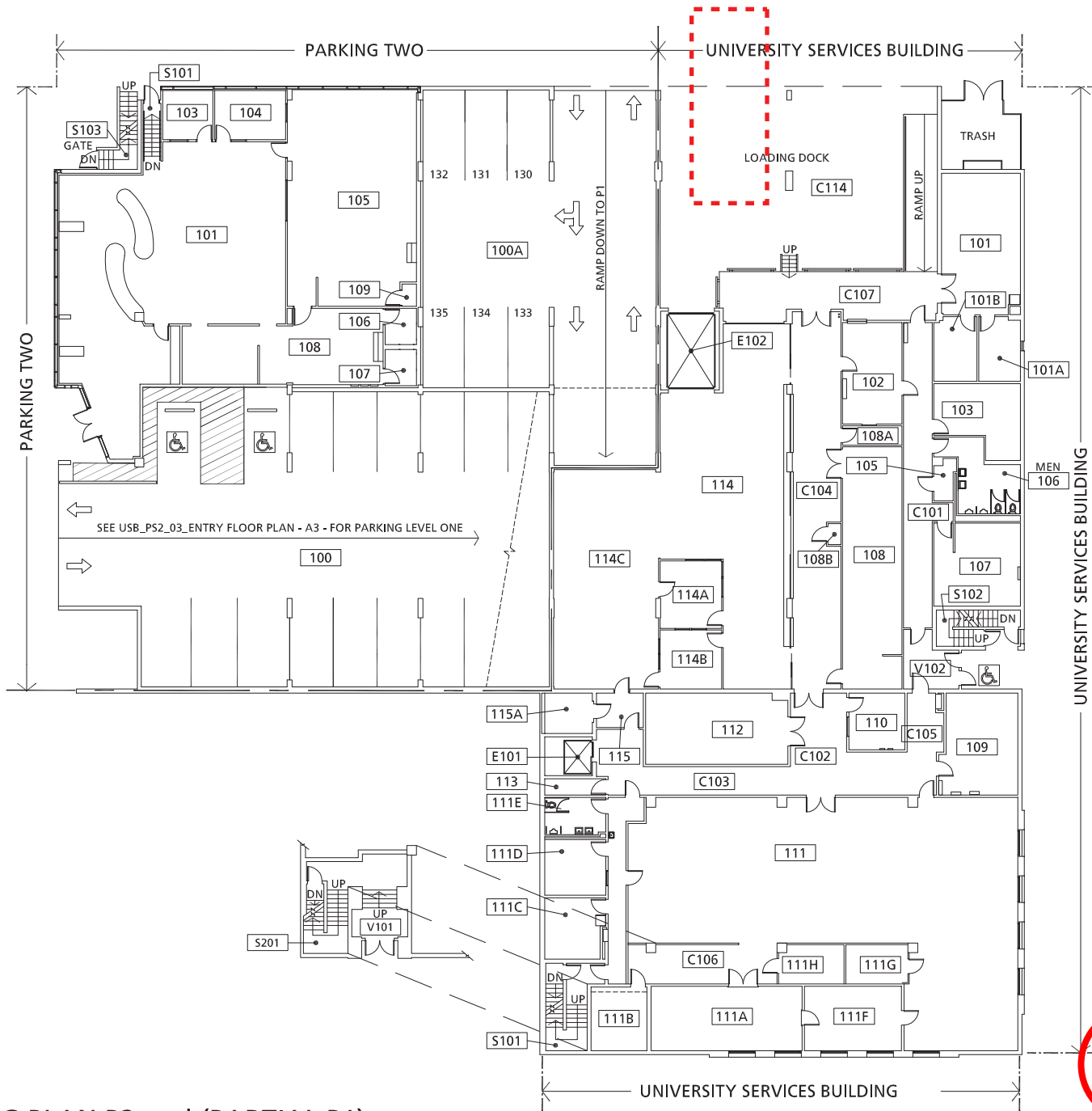

Gear is on Level 3. Generator can be placed on loading dock sidewalk area and be fed up the side of the parking structure.

8a



PARKING PLAN P2 and (PARTIAL P1)

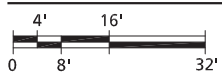

189 - A2

DRAWN BY:
LRR
DATE:
8/2011

**PARKING PLAN P2 and (PARTIAL P1)
189, PARKING TWO
1724 S. W. BROADWAY**

FACILITIES
617 SOUTHWEST
MONTGOMERY STREET
PORTLAND, OR. 97201
www.fac.pdx.edu
TEL: 503-725-3738
FAX: 503-725-4329

**PORTLAND
STATE
UNIVERSITY**

189 - A5

DRAWN BY:
LRR
DATE:
8/2011

PARKING PLAN P5
189, PARKING TWO
1724 S. W. BROADWAY

FACILITIES
617 SOUTHWEST
MONTGOMERY STREET
PORTLAND, OR. 97201
www.fac.pdx.edu
TEL: 503-725-3738
FAX: 503-725-4329

PORTLAND
STATE
UNIVERSITY

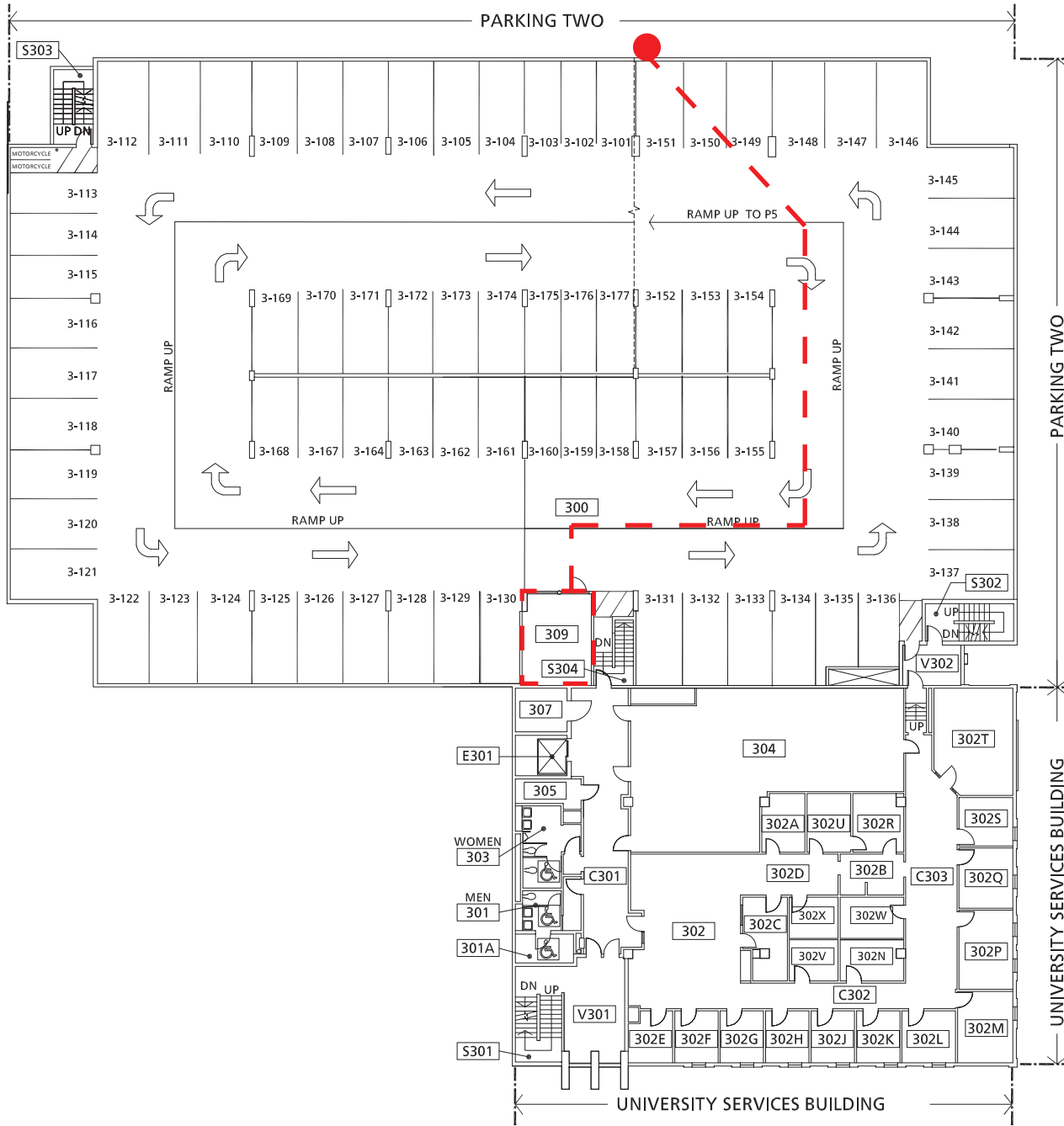

8b



PARKING PLAN P5

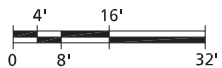

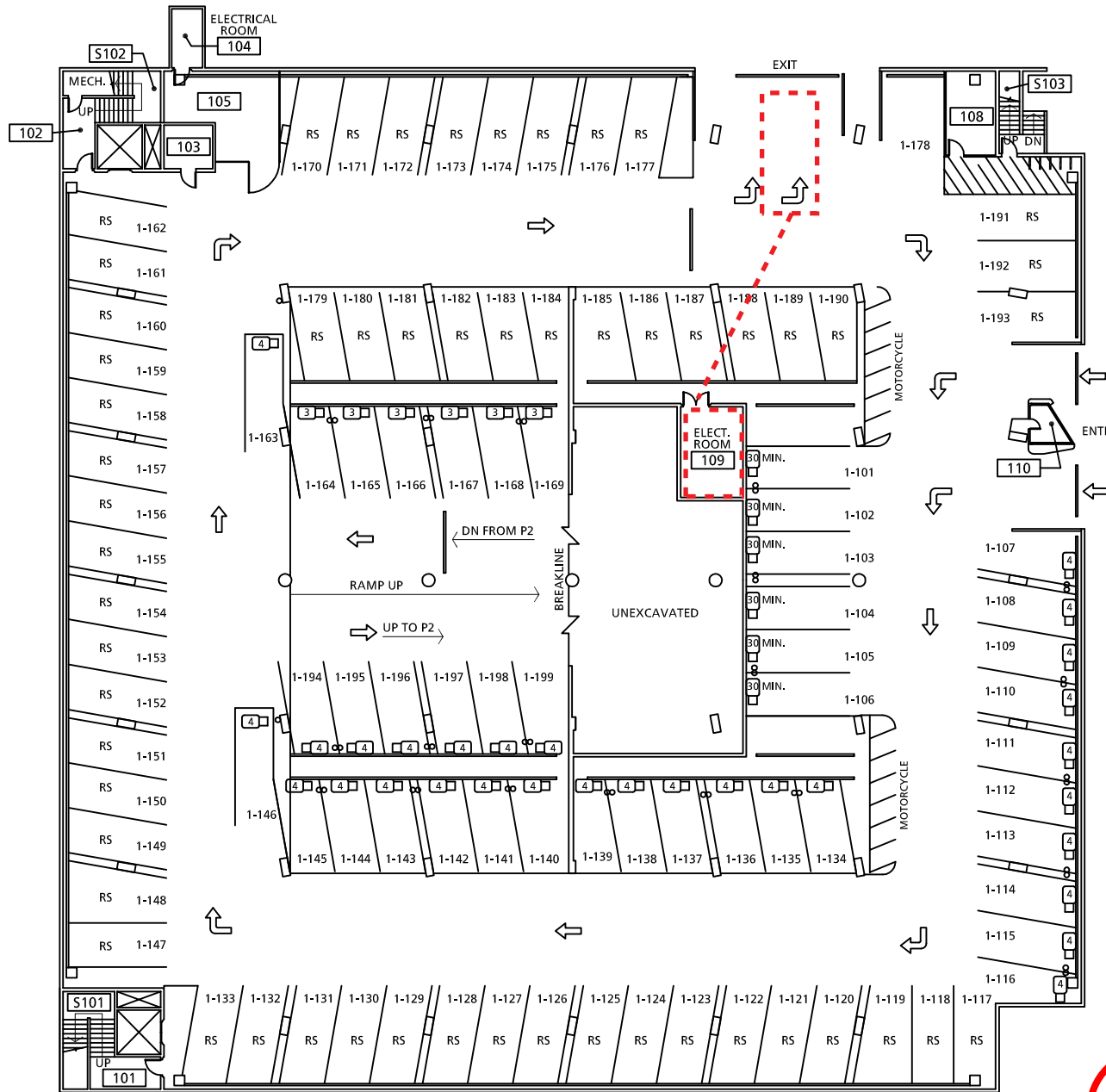

City of Portland will not allow generator on the street.
 A smaller generator would have to sit inside the Parking Structure.

191 - A1

DRAWN BY:
 LRR
 DATE:
 01/20/2009

PARKING PLAN ONE (BASEMENT)
 191, PARKING STRUCTURE 1 (ONE)
 1872 S.W. BROADWAY

FACILITIES
 617 SOUTHWEST
 MONTGOMERY STREET
 PORTLAND, OR. 97201
 EMAIL: WWW.PDX.EDU
 TEL: 503-725-3738
 FAX: 503-725-4329

PORTLAND
 STATE
 UNIVERSITY

PARKING PLAN ONE (BASEMENT)

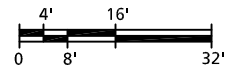

9a



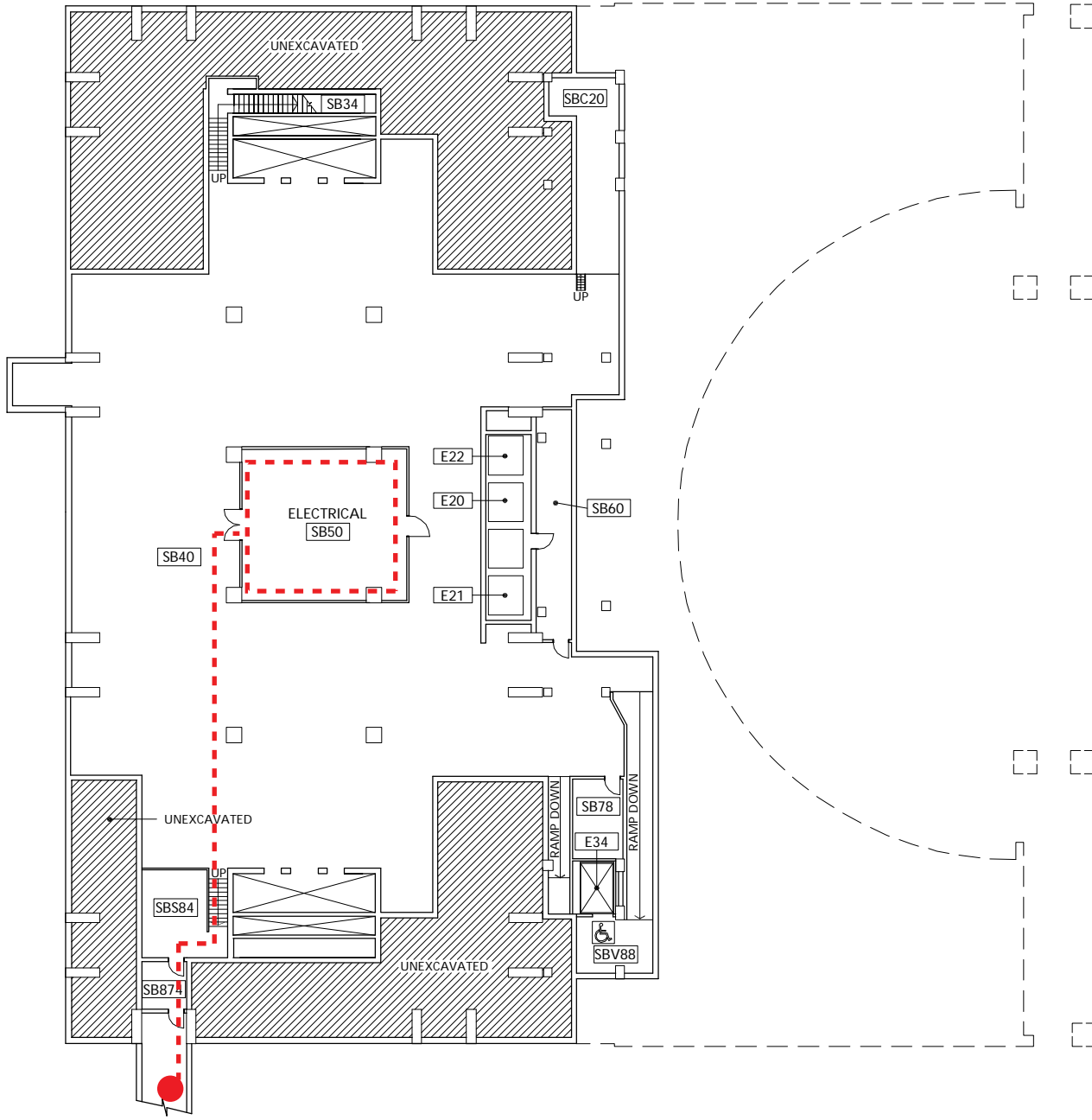

SUB-BASEMENT FLOOR PLAN

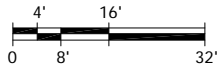

10a



Generator placement is the same location at Peter Stott Center and fed from the PSC utility tunnel. See PSC drawings for more details.

230 - A1

DRAWN BY:
LRR
DATE:
5/12/2003

SUB-BASEMENT FLOOR PLAN
230, MILLAR LIBRARY
1875 S.W. PARK AVENUE

FACILITIES
617 SOUTHWEST
MONTGOMERY STREET
PORTLAND, OR. 97201
www.fac.pdx.edu
TEL: 503-725-3738
FAX: 503-725-4329

PORTLAND
STATE
UNIVERSITY

227 - A2

DRAWN BY:
LRR
DATE:
8/2011

FIRST FLOOR PLAN
EXTENDED STUDIES BUILDING
1633 S.W. PARK

FACILITIES
617 SOUTHWEST
MONTGOMERY STREET
PORTLAND, OR. 97201
www.fac.pdx.edu
TEL: 503-725-3738
FAX: 503-725-4329

PORTLAND
STATE
UNIVERSITY

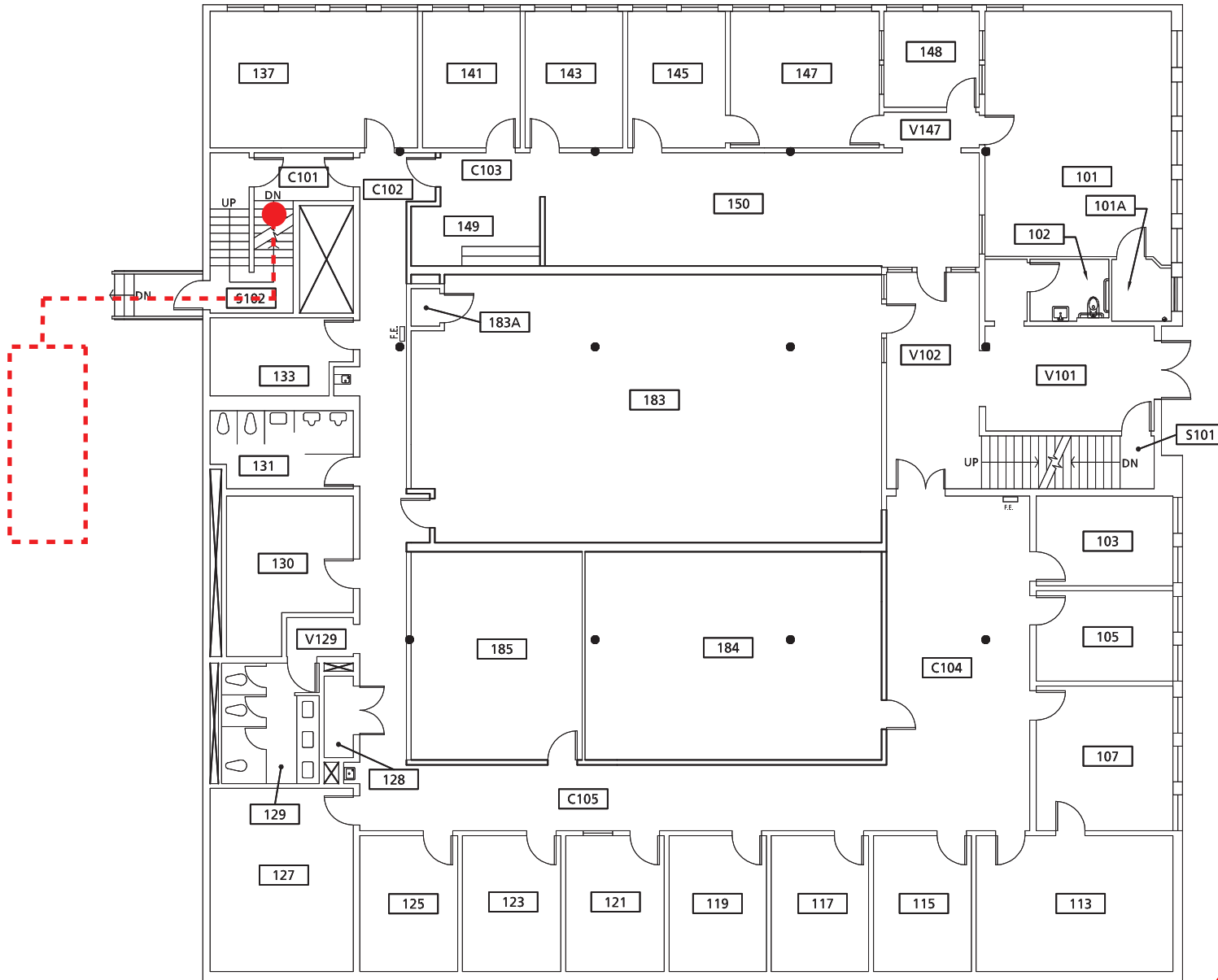

FIRST FLOOR PLAN

